

Nail plate NPB255 has been developed to fix Timber to Timber, Timber to concrete supports and CLT panels to CLT Floors or concrete support.



[UK-DoP-h10/0005](#)

FEATURES



Material

- Galvanized steel S250GD + Z275 according to EN 10346
- Thickness 3 mm

Advantages

- Ideal for use in Timber and CLT buildings
- Great versatility: can be utilised for Timber to Timber, Timber to concrete, CLT to CLT or CLT to concrete connections,
- High performance for horizontal (F_2 / F_3) and vertical (F_1) loads directions.

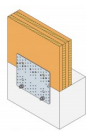
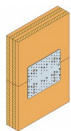

APPLICATIONS

TECHNICAL DATA

Product Dimensions

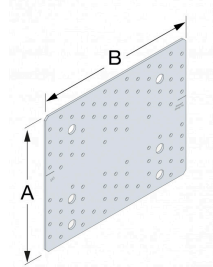
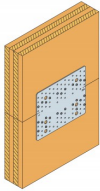

References	Dimensions [mm]		
	A	B	t
NPB255	214	255	3

Product Characteristic Capacities - Timber to Timber - Nailing Pattern 1

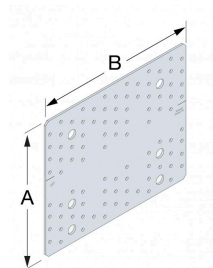
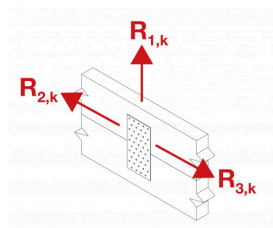
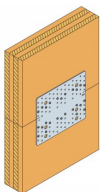

References	Product capacities - Timber to timber - Nailing pattern 1					
	Fasteners		Product characteristic capacities - Timber C24 [kN]			
	Top part	Bottom part	$R_{1,k}$		$R_{2,k}$	
			CNA4.0x50	CSA5.0x50	CNA4.0x50	CSA5.0x50
NPB255	11	15	23.9	27.6	20.8	24

- The timber member must be prevented from rotation (by other means)

Product Characteristic Capacities - Timber to Timber - Nailing Pattern 2

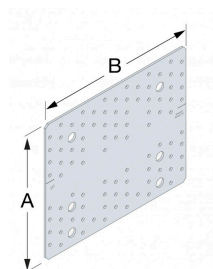
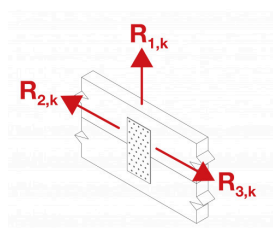
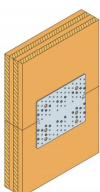

References	Product capacities - Timber to timber - Nailing pattern 2					
	Fasteners		Product characteristic capacities - Timber C24 [kN]			
	Top part	Bottom part	$R_{1,k}$	$R_{2,k}$		
			CNA4.0x50	CSA5.0x50	CNA4.0x50	CSA5.0x50
NPB255	13	15	28.3	32.6	19.4	22.3

- The timber member must be prevented from rotation (by other means)

Product Characteristic Capacities - Timber to Timber - Nailing Pattern 3

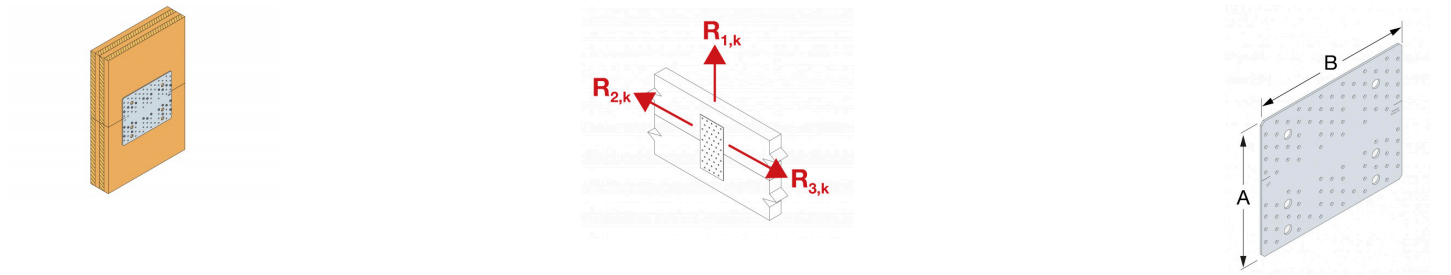

References	Product capacities - Timber to timber - Nailing pattern 3		
	Fasteners		Product characteristic capacities - Timber C24 [kN]
	Top part	Bottom part	$R_{2,k}$
			CSA5.0x50
NPB255	11	15	20.7

- The timber member must be prevented from rotation (by other means)

Product Characteristic Capacities - Timber to Timber - Nailing Pattern 4

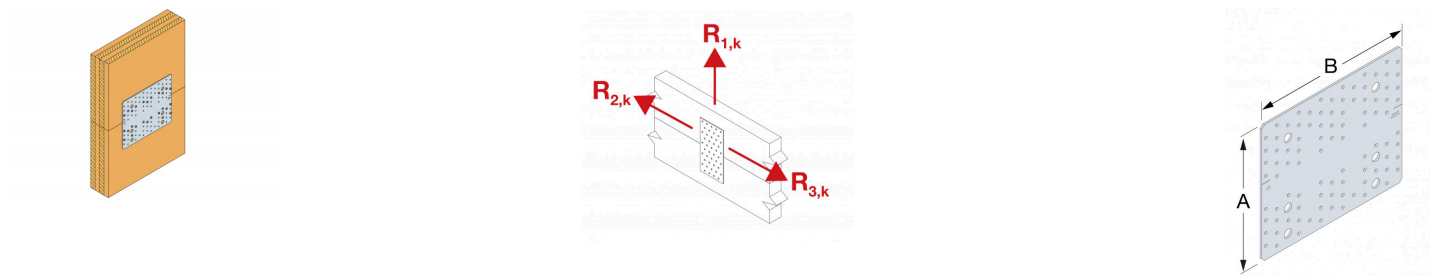

References	Product capacities - Timber to timber - Nailing pattern 4		
	Fasteners		Product characteristic capacities - Timber C24 [kN]
	Top part	Bottom part	$R_{2,k}$
			CSA5.0x50
NPB255	17	24	27.8

- The timber member must be prevented from rotation (by other means)

Product Characteristic Capacities - Timber to Timber - Nailing Pattern 5

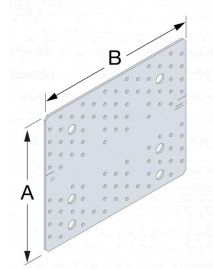
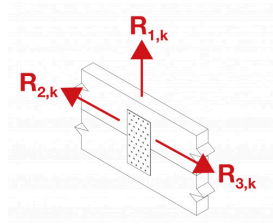
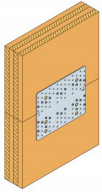

References	Product capacities - Timber to timber - Nailing pattern 5		
	Fasteners		Product characteristic capacities - Timber C24 [kN]
	Top part	Bottom part	$R_{2,k}$ CSA5.0x50
NPB255	16	23	30.6

- The timber member must be prevented from rotation (by other means)

Product Characteristic Capacities - Timber to Timber - Nailing Pattern 6

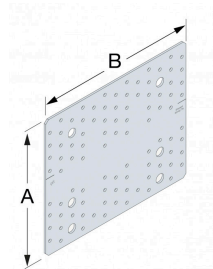
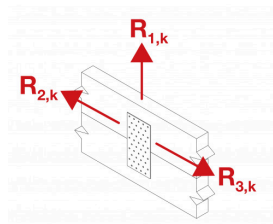
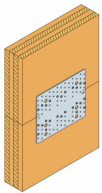

References	Product capacities - Timber to timber - Nailing pattern 6		
	Fasteners		Product characteristic capacities - Timber C24 [kN]
	Top part	Bottom part	$R_{2,k}$ CSA5.0x50
NPB255	30	34	44

- The timber member must be prevented from rotation (by other means)

Product Characteristic Capacities - Timber to Rigid Support - Nailing Pattern 1

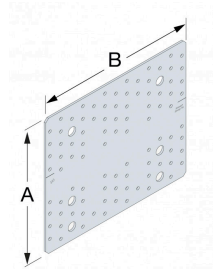
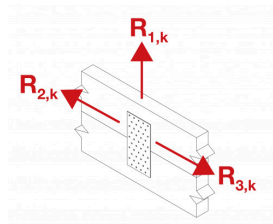
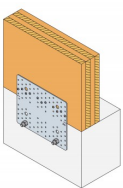

References	Product capacities - Timber to Rigid support - Nailing pattern 1					
	Fasteners		Product characteristic capacities - Timber C24 [kN]			
	Top part	Bottom part	$R_{1,k}$		$R_{2,k}$	
			CNA4.0x50	CSA5.0x50	CNA4.0x50	CSA5.0x50
NPB255	11	2	23.9	27.6	22.8	26.3

- The timber member must be prevented from rotation (by other means)
- The group composed of two anchors shall be checked with shear loads F_1 and F_2 , and a moment applied at the middle between the two anchor is equal to $F_2 \cdot 120\text{mm}$ (spacing of anchors: 160 mm)

Product Characteristic Capacities - Timber to Rigid Support - Nailing Pattern 2

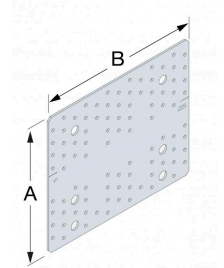
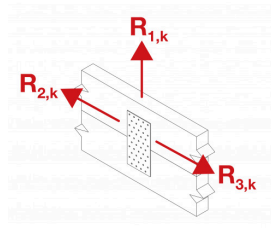
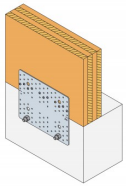

References	Product capacities - Timber to Rigid support - Nailing pattern 2					
	Fasteners		Product characteristic capacities - Timber C24 [kN]			
	Top part	Bottom part	$R_{1,k}$		$R_{2,k}$	
			CNA4.0x50	CSA5.0x50	CNA4.0x50	CSA5.0x50
NPB255	-	-	-	-	-	-

- The timber member must be prevented from rotation (by other means)
- The group composed of two anchors shall be checked with shear loads F_1 and F_2 , and a moment applied at the middle between the two anchor is equal to $F_2 \cdot 120\text{mm}$ (spacing of anchors: 160 mm)

INSTALLATION

Fasteners

CLT Connection:

- CNA annular ring shank nails dia. 4.0 x 50 mm,
- CSA screws dia. 5.0 x 40 mm.

Concrete Connection :

- Mechanical anchor: M12
- Chemical anchor: AT-HP resin + LMAS M12-150/35 threaded rod.

Applications

Nailing pattern



Bois sur bois

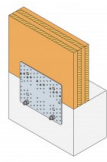

Bois sur béton