

Post base type PLO1 has been specially designed to take heavy uplift loads. It is suitable for environments subject to strong storms encountered in tropical climates.



[ETA-07/0285](#), [ES-DoP-e07/0285](#)

CARACTERÍSTICAS



EXTERIOR



GALVA

Materia

- S235JR according to EN 10025
- Hot dip galvanizing according to EN ISO 1461 (60 µm)

Ventajas

- Resistant to heavy loads
- Can be used in environments with risk of strong winds

APLICACIONES

Type

- Main post in a building

DATOS TÉCNICOS

Product dimensions

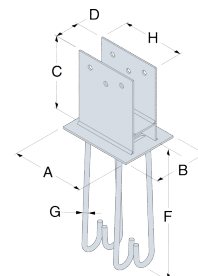
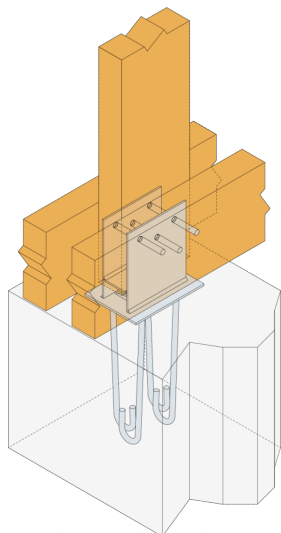

| Modelo | Dimensiones [mm] | | | | | | | | | Acabado | Holes |
|--------|------------------|-----|-----|------|-----|----|------|----------------|----------------|-----------------------|-------|
| | A | B | C | D | F | F | Esp. | t ₁ | t ₂ | | Ø13 |
| PLO1 | 200 | 150 | 200 | 67.5 | 345 | 12 | 170 | 5 | 5 | Galvanisation à chaud | 6 |

Product characteristic capacities - Configuration 1

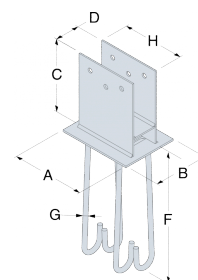
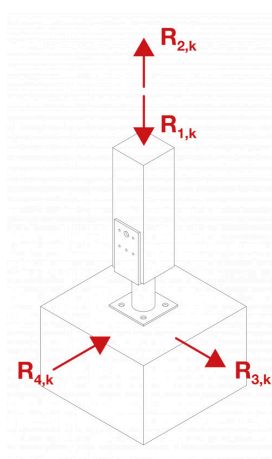
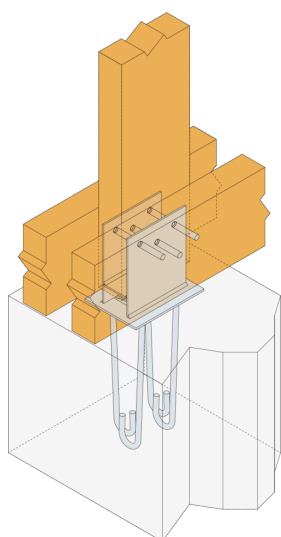

| Modelo | Product capacities - Timber to Concrete | | | | |
|--------|---|---------|---|------------------------|-----------|
| | Fasteners | | Characteristic capacities - Timber C24 [kN] | | |
| | On post | | $R_{1,k} = R_{2,k}$ | $R_{3,k}$ | $R_{4,k}$ |
| Qty | Type | | | | |
| PLO1 | 3 | Ø12x180 | 37.8 | min (17,8 ; 23,5/kmod) | 17.1 |

Capacities are valid for STD dowel or equivalent with $f_{ud,k} \geq 340 \text{ N/mm}^2$.

Other capacities values are available with other types of fasteners. Please refer to our ETA-07/0285.

Product characteristic capacities - Configuration 2

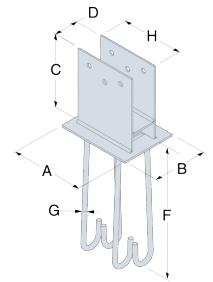
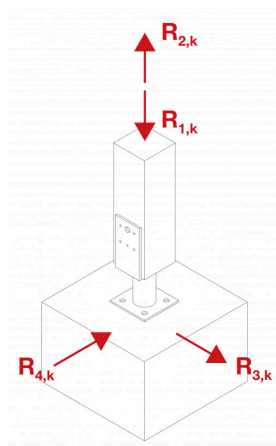
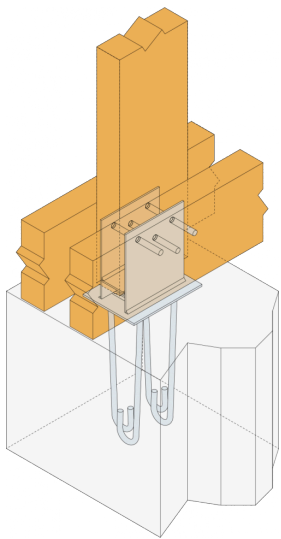

| Modelo | Product capacities - Timber to Concrete | | | | | | |
|--------|---|----------|---|----------|----------------|-----------|-----------|
| | Fasteners | | Characteristic capacities - Timber C24 [kN] | | | | |
| | On post | | $R_{1,k} = R_{2,k}$ | | $R_{3,k}^{**}$ | | $R_{4,k}$ |
| Qty | Type | Internal | External* | Internal | External | | |
| PLO1 | 3 | Ø12x180 | 43.4 | 24.7 | 23.1 | 23,5/kmod | 17.1 |

Capacities are valid for STD dowel or equivalent with $f_{ud,k} \geq 340 \text{ N/mm}^2$.

Other capacities values are available with other types of fasteners. Please refer to our ETA-07/0285.

INSTALACIÓN

Fijaciones

- Onto wood: bolts, wood screws Ø12 mm
- Onto concrete: sealing of round iron in the concrete block