

FM-MP3 evo

Vrouwelijke metalen plug voor zware belasting optie 7

De metalen plug FM-MP3 EVO met schroefexpansiehuls in 3 segmenten is geschikt voor het bevestigen van elementen voor het overbrengen van zware belastingen in een groot aantal ondergronden: gescheurd of ongescheurd beton, volle of holle ondergronden.

Kenmerken

Materiaal

- Elektrolytisch verzinkt staal.

Voordelen

- Universele metalen plug, ook geschikt voor hol metselwerk,
- Body uit één stuk, met een exclusief kegelhechtingssysteem,
- Brandwerendheid R120.

Toepassingen

Toepassingsgebieden

- Borstweringen,
- Veiligheidsbarrières,
- Uitrustingen, diverse niet-structurele toepassingen.

Ondergrond

- Gescheurd beton,
- Ongescheurd beton,
- Vol metselwerk,
- Steen,
- Alveolaire baksteen (compatibiliteit te controleren).



FM-MP3 evo

Vrouwelijke metalen plug voor zware belasting optie 7

Technische gegevens

Afmetingen

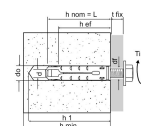

Referentie	Product Reference	Dimensions [ØxL] [mm]	Max. fixture thickness [t _{fix}] [mm]	Hole diameter [d _o] [mm]	Min. hole depth [h ₁] [mm]	Nominal embedment depth [h _{nom}] [mm]	Min. setting depth [h _{ef}] [mm]	Hole diameter in fixing element [d _f] [mm]	Min. fixture thickness [h _{min}] [mm]	Torque [T _{inst}] [Nm]	Qty per box
73300B1004500	FM-MP3 evo	M6x45*	-	10	60	45	36	8	100	8	50
73300B1205000		M8x50*	-	12	70	50	43	10	100	15	50
73300B1506000		M10x60*	-	15	80	60	50	12	100	30	25
73300B1808000		M12x80*	-	18	100	80	69	14	140	50	20

*Certified product when coupled with hex head screw DIN933 grade 8.8 and washer DIN125-1 (t_{fix} = L_v - h_{nom})

Product Dimensions Hex Head Screw

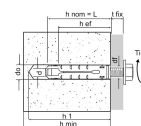

Referentie	Product Reference	Dimensions [ØxL] [mm]	Max. fixture thickness [t _{fix}] [mm]	Hole diameter [d _o] [mm]	Min. hole depth [h ₁] [mm]	Nominal embedment depth [h _{nom}] [mm]	Min. setting depth [h _{ef}] [mm]	Hole diameter in fixing element [d _f] [mm]	Min. fixture thickness [h _{min}] [mm]	Thread length [L _v] [mm]	Torque [T _{inst}] [Nm]
73301B1004500	FM-MP3 evo	M6x45	5	10	60	45	36	8	100	50	
73301B1205000		M8x50	10	12	70	50	43	10	100	60	
73301B1506000		M10x60	20	15	80	60	50	12	100	80	

** Not covered by CE certification

FM-MP3 evo

Vrouwelijke metalen plug voor zware belasting optie 7

Design capacities - single anchor - no edge distances

Referentie	Product Reference	Dimensions [ØxL] [mm]	Design capacity - Non-cracked concrete (3)								Bending moment MRd [Nm]
			Tension - NRd (1)				Shear - VRd (1-2)				
			C20/25 [kN]	C30/37 [kN]	C40/50 [kN]	C50/60 [kN]	C20/25 [kN]	C30/37 [kN]	C40/50 [kN]	C50/60 [kN]	
73300B1004500	FM-MP3 evo	M6x45*	5	-	-	-	5.1	-	-	-	9.6
73300B1205000	FM-MP3 evo	M8x50*	8	-	-	-	9.3	-	-	-	24
73300B1506000	FM-MP3 evo	M10x60*	1.6	-	-	-	11.6	-	-	-	48
73300B1808000	FM-MP3 evo	M12x80*	16.7	-	-	-	27	-	-	-	84
73301B1004500	FM-MP3 evo	M6x45	5	-	-	-	5.1	-	-	-	9.6
73301B1205000	FM-MP3 evo	M8x50	8	-	-	-	9.3	-	-	-	24
73301B1506000	FM-MP3 evo	M10x60	11.6	-	-	-	11.6	-	-	-	48

1. The design loads have been calculated using the partial safety factors for resistances stated in ETA-approval(s). The loading figures are valid for unreinforced concrete and reinforced concrete with a rebar spacing $s \geq 15$ cm (any diameter) or with a rebar spacing $s \geq 10$ cm, if the rebar diameter is 10mm or smaller.

2. The figures for shear are based on a single anchor without influence of concrete edges. For anchorages close to edges ($c \leq \max [10 \text{ hef}; 60d]$) the concrete edge failure shall be checked per ETAG 001, Annex C, design method A.

3. Concrete is considered non-cracked when the tensile stress within the concrete is $\sigma_L + \sigma_R \leq 0$. In the absence of detailed verification $\sigma_R = 3 \text{ N/mm}^2$ can be assumed (σ_L equals the tensile stress within the concrete induced by external loads, anchors loads included).

** Not covered by CE certification

FM-MP3 evo

Vrouwelijke metalen plug voor zware belasting optie 7

Plaatsing

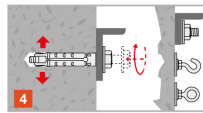
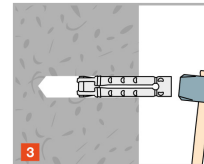
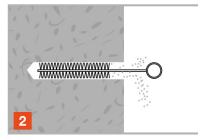
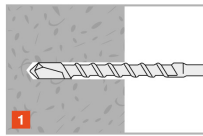

Installation data

Referentie	Product Reference	Dimensions [ØxL] [mm]	Ø drilling hole [d0] [mm]	Min. drill depth [h1] [mm]	Ø drilling fixture [df] [mm]	Installation torque [Tinst] [Nm]	Embedment depth [hef] [mm]	Min. support thickness [hmin] [mm]
73300B1004500	FM-MP3 evo	M6x45*	10	60	8	8	36	100
73300B1205000	FM-MP3 evo	M8x50*	12	70	10	15	43	100
73300B1506000	FM-MP3 evo	M10x60*	15	80	12	30	50	100
73300B1808000	FM-MP3 evo	M12x80*	18	100	14	50	69	140
73301B1004500	FM-MP3 evo	M6x45	10	60	8	8	36	100
73301B1205000	FM-MP3 evo	M8x50	12	70	10	15	43	100
73301B1506000	FM-MP3 evo	M10x60	15	80	12	30	50	100

** Not covered by CE certification

Spacings and edge distances - ETA-09/0067

Referentie	Product Reference	Dimensions [ØxL] [mm]	Min. edge distance [cmin] [mm]	Min. spacing [smin] [mm]	Characteristic edge distance [ccr,N] [mm]	Characteristic spacing(5) - Scr,N [scr,N] [mm]
73300B1004500	FM-MP3 evo	M6x45*	35	35	54	108
73300B1205000	FM-MP3 evo	M8x50*	45	45	65	130
73300B1506000	FM-MP3 evo	M10x60*	50	50	75	150
73300B1808000	FM-MP3 evo	M12x80*	75	75	104	208

* The above table values also apply to: evo S

FM-MP3 evo

Vrouwelijke metalen plug voor zware belasting optie 7

ZAC des Quatre Chemins - 85400 Sainte
Gemme la Plaine - France
tél : +33 2 51 28 44 00
fax : +33 2 51 28 44 01

Copyright by Simpson Strong-Tie®

Informatie weergegeven op deze website zijn eigendom van Simpson Strong-Tie®
Deze zijn enkel geldig in associatie met de gecommercialiseerde Simpson Strong-Tie® producten

FM-MP3 evo

**Vrouwelijke metalen plug voor zware
belasting optie 7**



www.strongtie.nl