

TAP

Vrouwelijke metalen inslagplug

De metalen inslagplug TAP met kraag Optie 7 en binnendraad M6 of M8 is geschikt voor het bevestigen van structurele elementen op ongescheurd beton en voor het bevestigen van diverse niet-structurele uitrustings-elementen op gescheurd of ongescheurd beton. Er kan een metrische schroef of draadstang worden ingebracht.

Kenmerken

Materiaal

- Elektrolytisch verzinkt staal.

Voordelen

- Veilige en gecontroleerde uitzetting,
- Snelle installatie,
- Gereduceerde verankeringsdiepte: kortere boortijd,
- kraag voor eenvoudige installatie gelijk met het oppervlak van de ondergrond,
- Hoge prestaties in verhouding tot de verankeringsdiepte,
- Brandwerendheid R120.

Toepassingen

Toepassingsgebieden

Ideaal voor alle soorten hangende uitrustingen:

- goten, rails,
- kabelhulzen en leidingen,
- Sprinkler-bevestiging.

Ondergrond

- gescheurd en ongescheurd beton voor niet-structurele toepassingen,
- ongescheurd beton voor structurele toepassingen,
- steen.

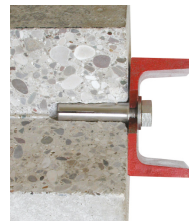

TAP
 Vrouwelijke metalen inslagplug

Technische gegevens

Product Dimensions

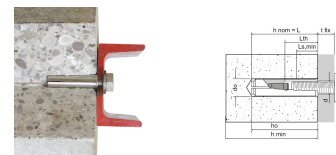

Referentie	Product Reference	Dimensions [dxL] [mm]	Hole diameter [d _o] [mm]	Cylindrical hole depth [h _o] [mm]	Nominal embedment depth [h _{nom}] [mm]	Threaded length [L _{th}] [mm]	Max. thread engagement [L _{s,min}] [mm]	Torque [T _{instl}] [Nm]	Qty per box	Qty per outer box
75205B0600000	TAP	M6x25*	8	25	25	11	6	4	100	2000
75205B0800000		M8x30	10	30	30	13	8	8	100	1000

* Only ETA 18/0433 ETAG 001 p.6 Multiple use

** Only ETA 18/0432 EAD-330232-00-0601 opt.7

Screw Length: Minimum: $L_{s,min} + t_{fix}$ - Maximum: $L_{th} + t_{fix}$

Design capacities - single anchor - no edge distances - ETA-18/0432

Referentie	Dimensions [dxL] [mm]	Recommended loads - Non-cracked concrete (3)								Bending moment M _{rec} [Nm]
		Tension - N _{rec} ⁽¹⁾				Shear - V _{rec} ⁽¹⁻²⁾				
		C20/25 [kN]	C30/37 [kN]	C40/50 [kN]	C50/60 [kN]	C20/25 [kN]	C30/37 [kN]	C40/50 [kN]	C50/60 [kN]	
75205B0600000	M6x25*	-	-	-	-	-	-	-	-	-
75205B0800000	M8x30	3.3	4	4.7	5.1	4	4.9	5.6	6.2	8.98
49902B060000C	-	-	-	-	-	-	-	-	-	-
49902B080000C	-	-	-	-	-	-	-	-	-	-

1. The design loads have been calculated using the partial safety factors for resistances stated in ETA-approval(s). The loading figures are valid for unreinforced concrete and reinforced concrete with a rebar spacing $s \geq 15$ cm (any diameter) or with a rebar spacing $s \geq 10$ cm, if the rebar diameter is 10mm or smaller.

2. The figures for shear are based on a single anchor without influence of concrete edges. For anchorages close to edges ($c \leq \max [10 \text{ hef}; 60d]$) the concrete edge failure shall be checked per ETAG 001, Annex C, design method A.

3. Concrete is considered non-cracked when the tensile stress within the concrete is $\sigma_L + \sigma_R \leq 0$. In the absence of detailed verification $\sigma_R = 3 \text{ N/mm}^2$ can be assumed (σ_L equals the tensile stress within the concrete induced by external loads, anchors loads included).

*Not covered by ETA-18/0432

TAP Vrouwelijke metalen inslagplug

Plaatsing

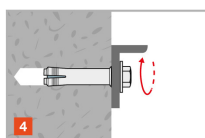
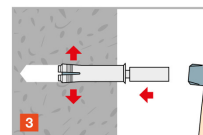
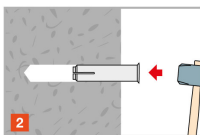
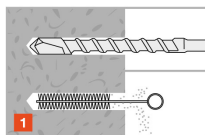

Installation data

Referentie	Product Reference	Dimensions [dxL] [mm]	Ø drilling hole [d0] [mm]	Min. drill depth [h1] [mm]	Ø drilling fixture [df] [mm]	Wrench size [SW] [mm]	Installation torque [Tinst] [Nm]	Embedment depth [hef] [mm]	Min. support thickness [hmin] [mm]
75205B0600000	TAP	M6x25*	8	25	7	-	4	25	-
75205B0800000	TAP	M8x30	10	30	9	-	8	30	100
49902B060000C	TAP Setting Tool	-	-	-	-	-	-	-	-
49902B080000C	TAP Setting Tool	-	-	-	-	-	-	-	-

Spacing and edge distances - ETA-18/0432

Referentie	Product Reference	Dimensions [dxL] [mm]	Min. edge distance [cmin] [mm]	Min. spacing [smin] [mm]	Characteristic edge distance [ccr,N] [mm]	Characteristic spacing(5) - Scr,N [scr,N] [mm]
75205B0600000	TAP	M6x25*	-	-	-	-
75205B0800000	TAP	M8x30	41	41	45	90
49902B060000C	TAP Setting Tool	-	-	-	-	-
49902B080000C	TAP Setting Tool	-	-	-	-	-

* Not included in the approval

