

END

Multi Angle Bracket

END type angle brackets have been completely redesigned for greater versatility in their applications.

Features

Material

- Galvanized steel S250GD + Z275 according to NF EN 10346.

Benefits

- Wide variety of uses.
- Wood to wood or wood to concrete.
- Oblong slot for simpler alignment and adjustment.

Applications

Header member

- Supporting member:** wood, concrete, steel, etc.
- Supported member:** PVC, wood, aluminium, steel joinery, etc.

For Use With

- Fastening of interior and exterior joinery, etc.

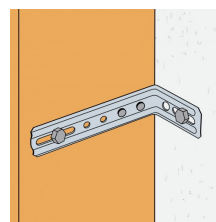
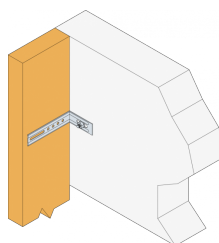
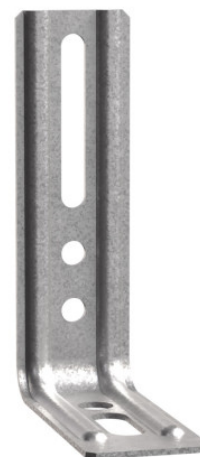

Timber to masonry connection

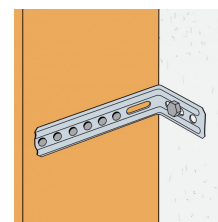

Timber to masonry connection

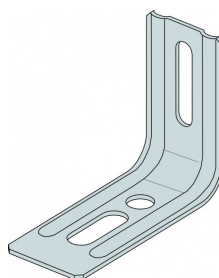

END

Multi Angle Bracket

Technical Data

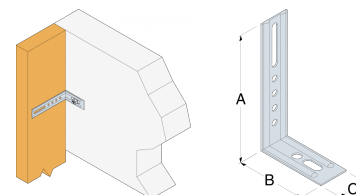

Dimensions and Allowable values

References	Dimensions and drill holes [mm]				Holes Flange A				Holes Flange B		Service loads according to DTU36.5 (french provision) [daN]	Weight [kg]
	A	B	C	t	Ø6.5	Ø6.5x20	Ø6.5x30	Ø6.5x45	Ø9	Ø9x20		
END40/1.5	40	71.5	30	1.5	-	1	-	-	1	1	R _{1,d} 14.5	0.032
END55/1.5	55	71.5	30	1.5	-	-	1	-	1	1	14.5	0.036
END70/1.5	70	71.5	30	1.5	-	-	-	1	1	1	14.5	0.04
END85/1.5	85	71.5	30	1.5	1	-	-	1	1	1	14.5	0.045
END100/1.5	100	71.5	30	1.5	2	-	-	1	1	1	14.5	0.05
END115/1.5	115	71.5	30	1.5	3	-	-	1	1	1	14.5	0.055
END130/1.5	130	71.5	30	1.5	4	-	-	1	1	1	14.5	0.06

END

Multi Angle Bracket

Installation

Fixing

On wood:

- CNA annular ring-shank nails 4.0 mm.
- CSA screw 5.0 mm.

On concrete:

- HIPC 8-60/20 drive anchors.

On metal:

- Bolts dia. 8 mm.

Installation

- Use appropriate screws.

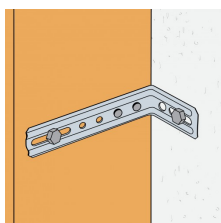

Timber to masonry connection

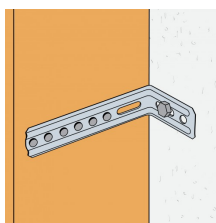

Timber to masonry connection

END

Multi Angle Bracket