

## Technical data sheet

**SIMPSON**

**Strong-Tie**

BAN-S

### Stainless steel bracing tape BAN

BAN bracing strips are used in roof constructions as drawbar.

## Features

### Material

- Steel quality:
  - Stainless Steel 1.4401 bzw. 1.4404 (V4A) in accordance with EN10088 standards.
  - Class III corrosion resistance

### Benefits

- **At higher loads can be mounted next to each other more tapes**
- **In these cases, it is recommended BNSP clamping device to allow a uniform tension belts.**

## Applications

### Header member

### Wood, wood materials

### Application area

- **Widely used in building construction, but serve mainly to reinforce the roof structure.**

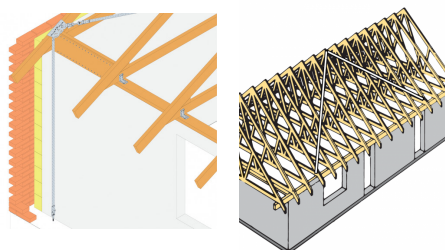

BAN-S  
Stainless steel bracing tape BAN

## Technical Data

Dimensions and drill holes

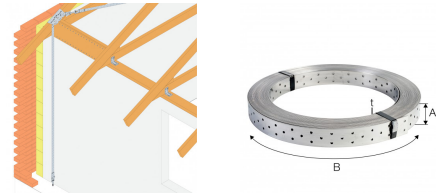

Table "Dimensions and drill holes" cannot be displayed : no references available.

Characteristic loadbearing table



Table "Characteristic loadbearing table" cannot be displayed : no references available.

BAN-S

**Stainless steel bracing tape BAN**

## Installation

### Fixing

- Connection to the timber is made CNA4,0xℓ nails or screws CSA5,0xℓ.
- Connection to Simpson Strong-Tie<sup>®</sup> wind bracing system using CLIPS20 or CLIPS23.

BAN-S

**Stainless steel bracing tape BAN**