

ABB40390S
ABB40390S

Stainless steel bracket 40390
Widely used, particularly where there are no demands for high loads.

Features

Material

Steel quality:

- **Stainless steel 1.4401 or 1.4404 (V4A), in accordance with EN10088.**
- **Resistance to acid - A4**

Benefits

- **load capacity in all directions, improved values at full and partial nailing**

Applications

Applicatons

Wood, other wood-based materials

Scope

- **Wood / Wood**



ABB40390S
ABB40390S

Technical Data

Product Dimensions

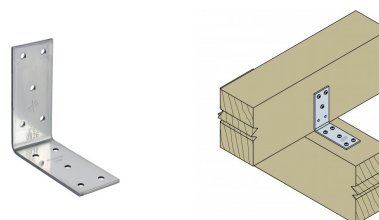
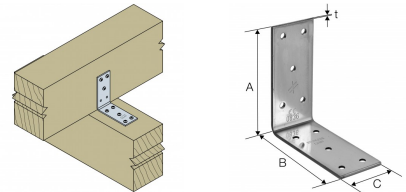

References	Tun / DB nr.	NOB nr.	Product Dimensions [mm]				Joist Ø5 [mm]	Holes flange B Ø5 [mm]	Box Quantity
			A	B	C	t			
ABB40390S	2914687	21221437	93	93	40	3	5	5	100

Capacities wood-wood connection - Full Nailing

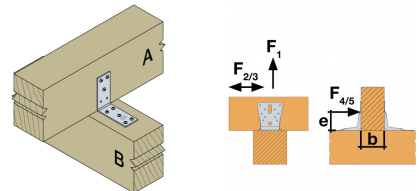

References	Product capacities - Timber to timber - Full nailing							
	Number of Fasteners		Characteristic capacities - Timber C24 - 2 angle brackets per connection [kN]					
	Joist	Flange B	R _{1,k}		R _{2,k} = R _{3,k}		R _{4,k} = R _{5,k} ⁽¹⁾	
	Qty	Qty	CNA4.0x40	CNA4.0x60	CNA4.0x40	CNA4.0x60	CNA4.0x40	CNA4.0x60
ABB40390S	3	5	min (3,0 ; 3,1 /kmod)	min (4,9; 4,4 /kmod)	2	2.8	1,4 /kmod ^{0,5}	1,9 /kmod 0,5

1) b = 75 mm ; e = 130 mm

Capacities wood-wood connection / partialnailing

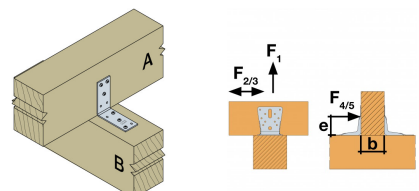

References	Product capacities - Timber to timber - Partial nailing							
	Number of Fasteners		Characteristic capacities - Timber C24 - 2 angle brackets per connection [kN]					
	Joist	Flange B	R _{1,k}		R _{2,k} = R _{3,k}		R _{4,k} = R _{5,k} ⁽¹⁾	
	Qty	Qty	CNA4.0x40	CNA4.0x60	CNA4.0x40	CNA4.0x60	CNA4.0x40	CNA4.0x60
ABB40390S	3	3	min (2,3; 2,0 /kmod)	min (3,1; 2,8 /kmod)	1.7	2.2	1,0 /kmod ^{0,5}	1,3 /kmod ^{0,5}

1) b = 75 mm ; e = 130 mm

Design

For the superimposition of the action be proved:

$$\sqrt{\left(\frac{F_{1,d}}{R_{1,d}} + \frac{F_{4/5,d}}{R_{4/5,d}}\right)^2 + \left(\frac{F_{2/3,d}}{R_{2/3,d}}\right)^2} \leq 1$$

ABB40390S
ABB40390S

Installation

Fasteners

- connections using screws or nails CSA5,0xI CNA4,0xI

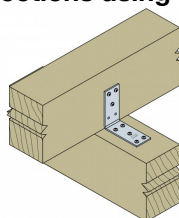

ABB40390S
ABB40390S

