

US40  
**US washer**

Pads of various sizes are designed to suit the products Simpson Strong-Tie®.

## Features

### Material

- **AH29050/2-FR**: galvanized steel S250GD + Z275 according to NF EN 10346.
- **US40/50/10G washer**: steel S235JR + hot-dip galvanized finish.

### Benefits

- Low-width anchor for use in frame uprights 45 mm wide.
- Anchors the wood-frame wall solidly into the ground (recommended in seismic zones).
- Reinforces the upright-lower plate connection by preventing the uplift of the upright.

**Thus, energy is dissipated in the panel through the stitching.**

## Applications

### Applicable materials

**Wood, wood products, steel**

### Application area

- **Load distribution in surface tension rods or angle**

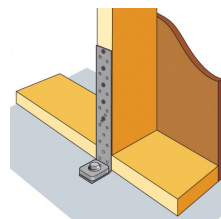
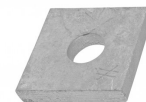
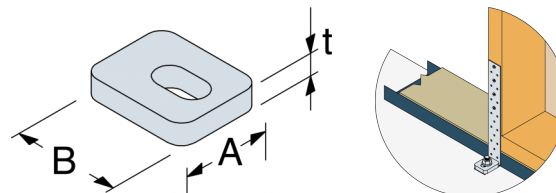

Fig. 1: Installation med 1 plade i bunden, 45 mm



US40  
US washer

## Technical Data



Dimensioner

AH 2 lisses basses 45mm

References	Dimensioner [mm]			
	A	B	Tykkelse	Holes
US40/40/10G-B	40	40	10	13.5
US40/50/10G-B	40	50	10	13,5x25
US50/50/8G-B	50	50	8	17.5

US40  
US washer

## Installation

### Installation

- Det er vigtigt at underlagsskiven vælges og vendes således, at skiven er tæt på beslagets bukketkant

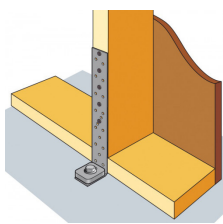

Fig. 1: Installation med 1 plade i bunden, 45 mm

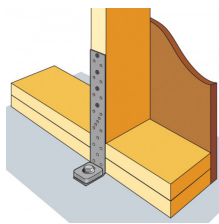

Fig. 2: Installation med 2 plader i bunden, 45 mm

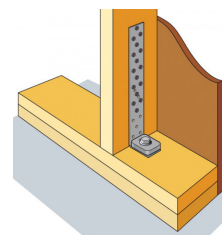

Fig. 3: Installation af indvendig væg



US40  
US washer

