

# Technical data sheet

**SIMPSON**  
**Strong-Tie**

ZYK / ZYKT  
**Zyklop**

CYCLOPS™ is a special connector that lets you connect sheet steel to wood components using an inclined plane fully threaded screw. The steel plate is imperative rectangular openings. Connection can be made on the side or end of the timber.

## Features

### Material

#### Steel quality:

**S355 J2 G3**

#### Corrosion protection:

**Galvanizing thickness of approx. 12 micron**

### Benefits

- With Cyclops™ can shear load of steel sheet effectively transferred using rotating screws on the wooden elements.
- Fully threaded screw is placed obliquely

## Applications

### Header member

**Wood, wood products, steel**

### For Use With

- The Cyclops™ is a connector which allows you to connect a steel plate to a timber member by oblique Fully Threaded screw.
- In the steel plates rectangular holes are only necessary.
- The connection can be made on the side or end of the timber

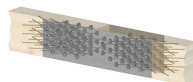
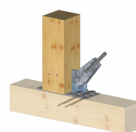
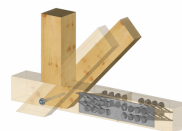
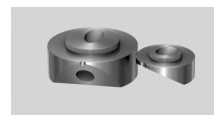
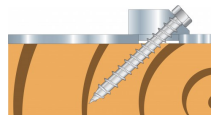

ZYK / ZYKT

**Zyklop**

**Technical Data**

Dimensions

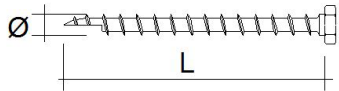
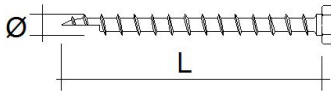
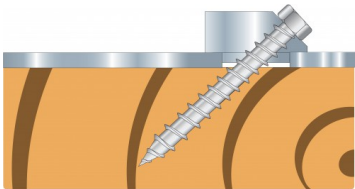

Table "Dimensions" cannot be displayed : no references available.

Capacities: screws

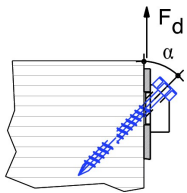
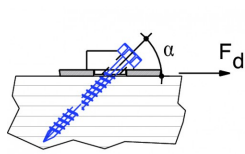

Table "Capacities: screws" cannot be displayed : no references available.

Capacities: ZYKLOP

Table "Capacities: ZYKLOP" cannot be displayed : no references available.

ZYK / ZYKT  
**Zyklop**

## Installation

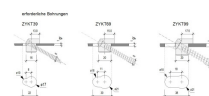

ZYK / ZYKT  
**Zyklop**

