

## Technical data sheet

**SIMPSON**

**Strong-Tie**

PPB

### Column Shoes type PB

These column bases are suitable for installation of supports / posts that are only subjected to pressure.

## Features

### Material

#### Steel quality:

**S 235 JR according to DIN EN 10025**

#### Corrosion protection:

**completely galvanized after processing; Zinc coating thickness about 55 microns in accordance with DIN EN 1461**

### Benefits

- The PPB support feet are height-adjustable and can be loaded vertically.
- You will be connected with anchor bolts on a concrete foundation.

## Applications

### Applicatons

#### **In Stock:**

- Concrete

#### **Component:**

- Wood, wood products

### Scope

- The column bases PPB / PPS suitable for installation of supports / posts that are only subjected to pressure.

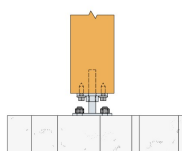
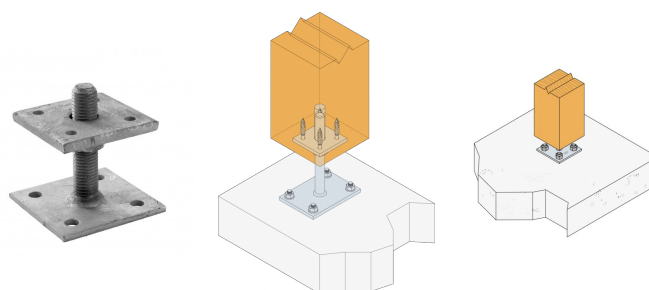

PPB

Column Shoes type PB

## Technical Data

### Product Dimensions

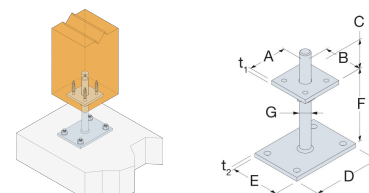

References	Tun / DB nr.	NOB nr.	Product Dimensions [mm]										Top plate holes		Bottom plate holes	No. of hexagon nuts	Box Quantity	Weight [kg]
			A	B	C	D	E	F	G	t <sub>1</sub>	t <sub>2</sub>	Ø5,5	Ø9	Ø12				
PPB70G-R	1389621	21594122	70	70	30-75	90	90	30-75	16	6	5	2	-	4	1	10	0.65	
PPB75G	5104688	22062798	80	80	22-67	90	90	30-75	20	8	5	-	4	4	1	20	0.91	
PPB80G	7742448	22062814	80	80	58-158	140	100	50-192	20	8	8	-	4	4	2	10	1.9	

### Capacities

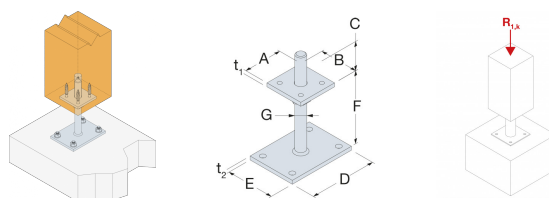

References	Number of Fasteners				Characteristic capacities - Timber C24 [kN]	
	On post		On concrete		R <sub>1,k</sub> [kN]	
	Qty	Type	Qty	Type	0 < F ≤ 100	100 < F ≤ 190
PPB70G-R	4	Ø8	4	Ø10	min (88.3 ; 63.9/kmod)	-
PPB75G	4	Ø8	4	Ø10	min (88.3 ; 63.9/kmod)	-
PPB80G	4	Ø8	4	Ø10	min (88.3 ; 63.9/kmod)	min (88.3 ; 57.9/kmod)

The following applies:

$$\frac{F_{i,d}}{R_{i,d}} \leq 1$$

PPB

**Column Shoes type PB**

## Installation

### Fasteners

- The PPB column base is similar to the concrete using anchors fixed, the PPS column base is concreted directly.
- The max. Distance from the molded base plate is 100mm, also applies to the PPS base support a in concrete of 200mm.
- The threaded rod is inserted through a hole (AE18 / AE22mm) in the support.
- A constructive position securing is done by means of screws or nails.

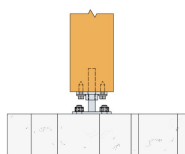
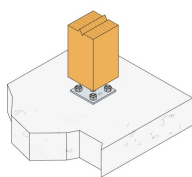

PPB

**Column Shoes type PB**