

Technical data sheet

SIMPSON

Strong-Tie

AC35350S

AC35350S - stainless steel bracket

For uniform load is recommended to use two angles for each joint. Combination wood / wood or wood / construction joints

Features

Material

Steel quality:

- **Stainless Steel 1.4401 bzw. 1.4404 (V4A) in accordance with EN10088 standards.**
- **Class III corrosion resistance**

Benefits

Benefits

- **Compact bracket**
- **Various connections nails, screws, etc.**

Applications

Applications

Wood, wood products, concrete

Scope

wood-wood connections in small wooden cross sections eg Purlins on main beam, window or window sill mounting.

- **Wood connector from the stainless steel with the O.A. Material number are suitable for outdoor use, including industrial and marine environment.**
- **The static values of the standard product for the stainless connector validity.**

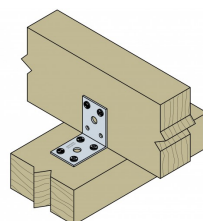

AC35350S

AC35350S - stainless steel bracket

Technical Data

Product Dimensions

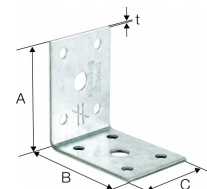
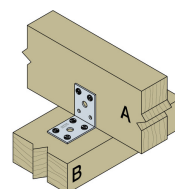

Table "Product Dimensions" cannot be displayed : no references available.

AC35350S

AC35350S - stainless steel bracket

Installation

Fasteners

- For joints wood / wood small cross, windows, windowsills

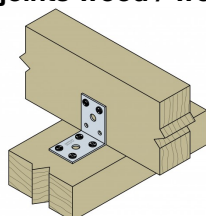

AC35350S

AC35350S - stainless steel bracket