

# Technical data sheet



ABB40390  
**ABB40390**

*General use, particularly where there are demands for high loads material*

## Features

### Material

#### **Steel quality:**

**Quality steel-S250GD + Z275 according to DIN EN10346**

#### **Corrosion protection:**

**275 g / m galvanized on both sides 20mm**

### Benefits

- **load capacity in all directions, improved values at full and partial nailing applicable materials**
- **wood, other wood-based materials**

## Applications

### Applicatons

**Wood, other wood-based materials**

### Scope

- **Wood / Wood**
- Values at full nailing**  
**Values partial nailing**



ABB40390  
**ABB40390**

## Technical Data

### Product Dimensions

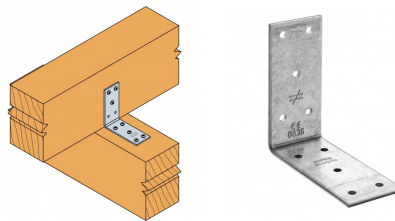
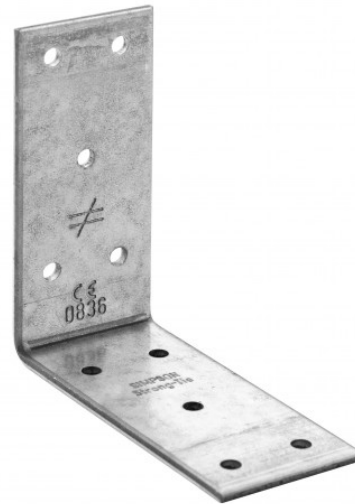
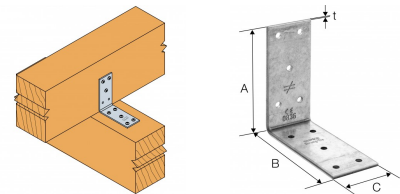

References	Tun / DB nr.	NOB nr.	Product Dimensions [mm]				Joist Ø5 [mm]	Holes flange B Ø5 [mm]	Box Quantity
			A	B	C	t			
ABB40390	3779360	21220843	93	93	40	3	5	5	100

### Capacities wood-wood connection - Full Nailing

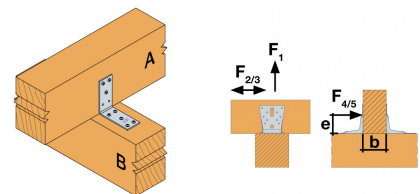

References	Product capacities - Timber to timber - Full nailing							
	Number of Fasteners		Characteristic capacities - Timber C24 - 2 angle brackets per connection [kN]					
	Joist	Flange B	R <sub>1,k</sub>		R <sub>2,k</sub> = R <sub>3,k</sub>		R <sub>4,k</sub> = R <sub>5,k</sub> <sup>(1)</sup>	
	Qty	Qty	CNA4.0x40	CNA4.0x60	CNA4.0x40	CNA4.0x60	CNA4.0x40	CNA4.0x60
ABB40390	3	5	min (3,0 ; 3,1 /kmod)	min (4,9; 4,4 /kmod)	2	2.8	1,4 /kmod <sup>0,5</sup>	1,9 /kmod <sup>0,5</sup>

1) b = 75mm ; e = 130mm

### Capacities wood-wood connection / partialnailing

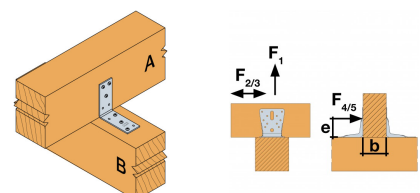

References	Product capacities - Timber to timber - Partial nailing							
	Number of Fasteners		Characteristic capacities - Timber C24 - 2 angle brackets per connection [kN]					
	Joist	Flange B	R <sub>1,k</sub>		R <sub>2,k</sub> = R <sub>3,k</sub>		R <sub>4,k</sub> = R <sub>5,k</sub> <sup>(1)</sup>	
	Qty	Qty	CNA4.0x40	CNA4.0x60	CNA4.0x40	CNA4.0x60	CNA4.0x40	CNA4.0x60
ABB40390	3	3	min (2,3; 2,0 /kmod)	min (3,1; 2,8 /kmod)	1.7	2.2	1,0 /kmod <sup>0,5</sup>	1,3 /kmod <sup>0,5</sup>

1) b = 75 mm ; e = 130 mm

#### Design

For the superimposition of the action be proved:

$$\sqrt{\left(\frac{F_{1,d}}{R_{1,d}} + \frac{F_{4/5,d}}{R_{4/5,d}}\right)^2 + \left(\frac{F_{2/3,d}}{R_{2/3,d}}\right)^2} \leq 1$$

ABB40390  
**ABB40390**

## Installation

Fasteners

- connections using screws or nails CSA5,0xI CNA4,0xI

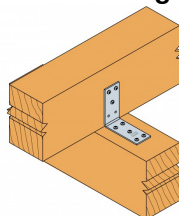

ABB40390  
**ABB40390**

