

Technical data sheet

SIMPSON**Strong-Tie**

X3 High Performance Long Plug

The X3 plugs in Ø8 and Ø10 mm versions in combination with countersunk / hexagon head screws are approved for multiple fixings in concrete and masonry.

Features

Material

Plug: nylon

Screw: white zinc plated steel

Benefits

- Extraordinary performance on all base materials.
- Up to 3 embedment depths
- Extreme versatility and significant reduction in installation time.
- Increased expansion
- Designed for facades and heavy carpentry.

Applications

Applications

- Ventilated facades
- Steel carpentry
- Wood carpentry

Suitable for

Non-cracked concrete

Solid brick

Honeycomb brick

- Cell like clay brick
- Lightweight honeycomb brick
- Hollow dense aggregate block
- Hollow light aggregate block
- Aerated concrete
- Solid stone



X3 High Performance Long Plug

Technical Data

Product Dimensions Countersunk TX Screw

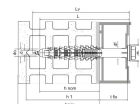

References	Product Reference	Plug [ØxL] [mm]	Screw [ØxL] [mm]	Reduced fixture thickness [t _{fix}] [mm]	Standard fixture thickness [t _{fix}] [mm]	Increased* fixture thickness [t _{fix}] [mm]	Ø drilling fixture [df] [mm]	Bit	Qty per box
64602B0806000	X3	Ø8x60	6x68	20	10	-	8.5	T-30	50
64602B0808000		Ø8x80	6x88	40	30	-	8.5	T-30	50
64602B0810000		Ø8x100	6x108	60	50	-	8.5	T-30	50
64602B0812000		Ø8x120	6x128	80	70	-	8.5	T-30	50
64602B1006000		Ø10x60	7x68	10	-	-	10.5	T-40	50
64602B1008000		Ø10x80	7x88	30	10	-	10.5	T-40	50
64602B1010000		Ø10x100	7x108	50	30	10	10.5	T-40	50
64602B1012000		Ø10x120	7x128	70	50	30	10.5	T-40	50
64602B1014000		Ø10x140	7x148	90	70	50	10.5	T-40	50
64602B1016000		Ø10x160	7x168	110	90	70	10.5	T-40	50
64602B1026000		Ø10x260	7x268	210	190	170	10.5	T-40	50
64602B1029000		Ø10x290	7x298	240	220	200	10.5	T-40	50

*Only for aerated concrete

NOTE: The thickness of the plaster must be included in the fixing thickness t_{fix}

Technical data sheet

X3 High Performance Long Plug

SIMPSON

Strong-Tie

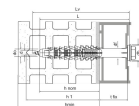

Product Dimensions Hex-head Screw

References	Product Reference	Plug [ØxL] [mm]	Screw [ØxL] [mm]	Reduced fixture thickness [t _{fix}] [mm]	Standard fixture thickness [t _{fix}] [mm]	Increased* fixture thickness [t _{fix}] [mm]	Ø drilling fixture [df] [mm]	Bit	Qty per box
64603B1006000	X3	Ø10x60	7x68	10	-	-	10.5	T-40	50
64603B1008000		Ø10x80	7x88	30	10	-	10.5	T-40	50
64603B1010000		Ø10x100	7x108	50	30	10	10.5	T-40	50
64603B1012000		Ø10x120	7x128	70	50	30	10.5	T-40	50
64603B1014000		Ø10x140	7x148	90	70	50	10.5	T-40	50
64603B1016000		Ø10x160	7x168	110	90	70	10.5	T-40	50

* Only for aerated concrete

NOTE: The thickness of the plaster must be included in the fixing thickness t_{fix}

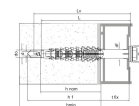

Product Dimensions Large Rim Plug with Hex-head screw

References	Product Reference	Plug [ØxL] [mm]	Screw [ØxL] [mm]	Reduced fixture thickness [t _{fix}] [mm]	Standard fixture thickness [t _{fix}] [mm]	Increased* fixture thickness [t _{fix}] [mm]	Bit	Qty per box
64703B1006000	X3	Ø10x60	7x68	10	-	-	T-40	50
64703B1008000		Ø10x80	7x88	30	10	-	T-40	50
64703B1010000		Ø10x100	7x108	50	30	10	T-40	50
64703B1012000		Ø10x120	7x128	70	50	30	T-40	50
64703B1014000		Ø10x140	7x148	90	70	50	T-40	50
64703B1016000		Ø10x160	7x168	110	90	70	T-40	50

*Only for aerated concrete

NOTE: The thickness of the plaster must be included in the fixing thickness t_{fix}

X3 High Performance Long Plug

Installation

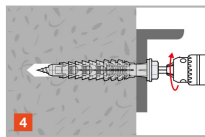
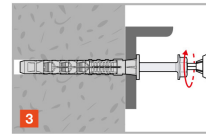
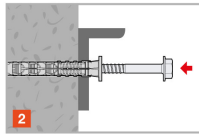
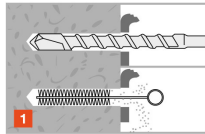

X3
High Performance Long Plug

