

END Multi Angle Bracket

END type angle brackets have been completely redesigned for greater versatility in their applications.

Features

Material

- Galvanized steel S250GD + Z275 according to NF EN 10346.

Benefits

- Wide variety of uses.
- Wood to wood or wood to concrete.
- Oblong slot for simpler alignment and adjustment.

Applications

Header member

- Supporting member:** wood, concrete, steel, etc.
- Supported member:** PVC, wood, aluminium, steel joinery, etc.

For Use With

- Fastening of interior and exterior joinery, etc.



INDOOR

Z275

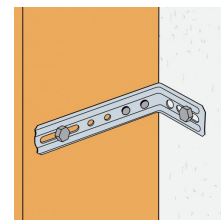
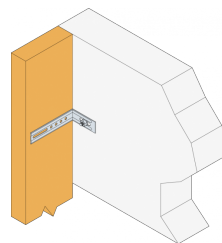
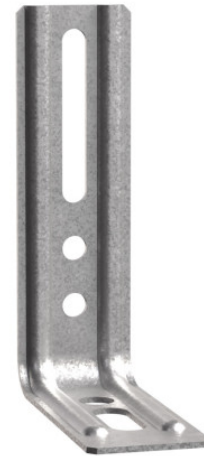

Timber to masonry connection

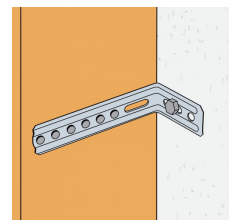

Timber to masonry connection

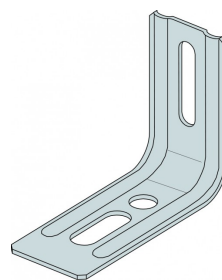

END
Multi Angle Bracket

Technical Data

Dimensions and Allowable values

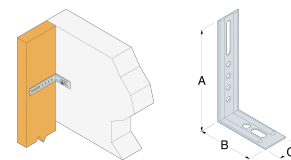

References	Dimensions and drill holes [mm]				Holes Flange A		Holes Flange B	
	A	B	C	t	Ø6.5	Obround	Ø9	Obround
END55/1.5C50	55	71.5	30	1.5	-	1 x Ø9x20	1	1 x Ø6.5x30
END100/1.5C50	100	71.5	30	1.5	2	1 x Ø9x20	1	1 x Ø6.5x45

END

Multi Angle Bracket

Installation

Fixing

On wood:

- CNA annular ring-shank nails 4.0 mm.
- CSA screw 5.0 mm.

On concrete:

- HIPC 8-60/20 drive anchors.

On metal:

- Bolts dia. 8 mm.

Installation

- Use appropriate screws.

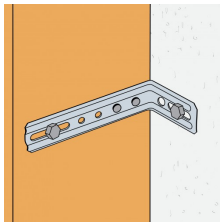

Timber to masonry connection

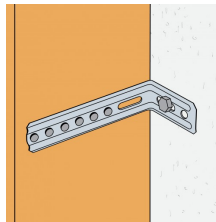

Timber to masonry connection

