

## HB Top Flange Engineered Joist Hanger

*The HB is a joist hanger for supporting I-joists and structural composite timber from timber headers. The HB is designed especially for use with single ply headers of thickness 89mm or more.*

### Features

#### Material

- Pre-galvanised mild steel

#### Installation

- Use all specified fasteners. Verify that the header can take the required fasteners specified in the table.
- Web stiffeners are required for use with the HB hanger styles.
- The HB hanger may be used for weld on applications. The minimum required weld for the top flanges is a 3.0 x 50mm fillet weld on each side of the top flange tabs.
- Weld-on applications produce maximum allowable loads listed.
- Uplift loads do not apply for this application.
- Special considerations should be taken when welding galvanised steel.

#### Options

- Other widths and heights are available as a special order, contact factory for details.
- HB series hangers can be skewed and sloped to a maximum of 45°. See table for load adjustment factors.

#### Options

- Other widths and heights are available as a special order, contact factory for details.
- HB series hangers can be skewed and sloped to a maximum of 45°. See table for load adjustment factors.

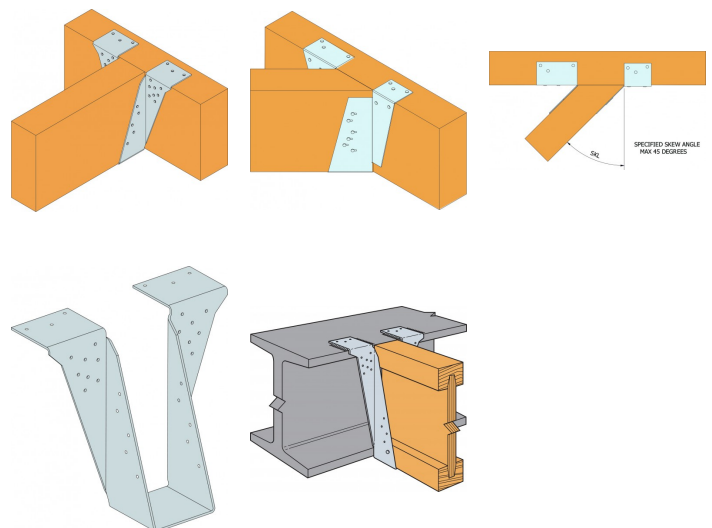

HB  
**Top Flange Engineered Joist Hanger**

## **Technical Data**

# Technical data sheet



## HB Top Flange Engineered Joist Hanger

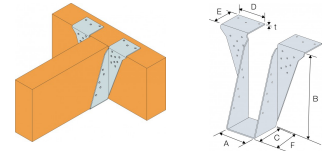

### Product Dimensions

References	Joist Size [mm]		Product Dimensions [mm]							Header holes Ø4.3 [mm]	Joist holes Ø4.3 [mm]
	Width	Height	A	B	C	D	E	F	t		
HB195/92	90	195	92	195	90	90	75	93	3	22	10
HB200/92	90	200	92	200	90	90	75	93	3	22	10
HB220/92	90	220	92	220	90	90	75	93	3	22	10
HB235/92	90	235	92	235	90	90	75	93	3	22	10
HB240/92	90	240	92	240	90	90	75	93	3	22	10
HB245/92	90	245	92	245	90	90	75	93	3	22	10
HB300/92	90	300	92	300	90	90	75	93	3	22	10
HB350/92	90	350	92	350	90	90	75	93	3	22	10
HB400/92	90	400	92	400	90	90	75	93	3	22	10
HB200/118	116	200	118	200	90	90	75	93	3	22	10
HB300/118	116	300	118	300	90	90	75	93	3	22	10
HB350/118	116	350	118	350	90	90	75	93	3	22	10
HB406/118	116	406	118	406	90	90	75	93	3	22	10
HB195/135	133	195	135	195	90	90	75	93	3	22	10
HB220/135	133	220	135	220	90	90	75	93	3	22	10
HB235/135	133	235	135	235	90	90	75	93	3	22	10
HB245/135	133	245	135	245	90	90	75	93	3	22	10
HB300/135	133	300	135	300	90	90	75	93	3	22	10
HB350/135	133	350	135	350	90	90	75	93	3	22	10
HB400/135	133	400	135	400	90	90	75	93	3	22	10
HB450/135	133	450	135	450	90	90	75	93	3	22	10
HB200/142	140	200	142	200	90	90	75	93	3	22	10
HB300/142	140	300	142	300	90	90	75	93	3	22	10
HB350/142	140	350	142	350	90	90	75	93	3	22	10
HB195/146	144	195	146	195	90	90	75	93	3	22	10
HB220/146	144	220	146	220	90	90	75	93	3	22	10
HB235/146	144	235	146	235	90	90	75	93	3	22	10
HB245/146	144	245	146	245	90	90	75	93	3	22	10
HB300/146	144	300	146	300	90	90	75	93	3	22	10
HB350/146	144	350	146	350	90	90	75	93	3	22	10
HB400/146	144	400	146	400	90	90	75	93	3	22	10
HB195/152	150	195	152	195	90	90	75	93	3	22	10
HB220/152	150	220	152	220	90	90	75	93	3	22	10
HB235/152	150	235	152	235	90	90	75	93	3	22	10
HB245/152	150	245	152	245	90	90	75	93	3	22	10
HB300/152	150	300	152	300	90	90	75	93	3	22	10
HB350/152	150	350	152	350	90	90	75	93	3	22	10
HB400/152	150	400	152	400	90	90	75	93	3	22	10
HB450/152	150	450	152	450	90	90	75	93	3	22	10
HB195/180	178	195	180	195	90	90	75	93	3	22	10
HB220/180	178	220	180	220	90	90	75	93	3	22	10
HB235/180	178	235	180	235	90	90	75	93	3	22	10
HB240/180	178	240	180	240	90	90	75	93	3	22	10
HB300/180	178	300	180	300	90	90	75	93	3	22	10
HB350/180	178	350	180	350	90	90	75	93	3	22	10

# Technical data sheet



## HB Top Flange Engineered Joist Hanger

References	Joist Size [mm]		Product Dimensions [mm]							Header holes	Joist holes
	Width	Height	A	B	C	D	E	F	t	Ø4.3 [mm]	Ø4.3 [mm]
HB356/180	178	356	180	356	90	90	75	93	3	22	10
HB400/180	178	400	180	400	90	90	75	93	3	22	10
HB406/180	178	406	180	406	90	90	75	93	3	22	10

### HB onto I-joists

References	Product capacities - HB onto I-Joist												
	Installation	Number of Fasteners					Safe Working Loads [kN]			Characteristic Capacities [kN]			
		Header			Joist		R <sub>1,SWL,Long Term</sub>			R <sub>1,k</sub>		R <sub>2,k</sub>	
		Top Qty	Type	Face Qty	Type	Qty	Type	I-Joist Headers with LVL Flanges ≥ 35mm	I-Joist Headers with Solid Sawn Flanges ≥ 45mm	R <sub>2,SWL, Short Term</sub>	I-Joist Headers with LVL Flanges ≥ 35mm		I-Joist Headers with Solid Sawn Flanges ≥ 45mm
HB	Backer Blocks	6	N3.75x30	16	N3.75x30	10	N3.75x30	12.9	13.6	5	30.2	30.2	8.8

### HB onto Solid Joists

References	HB onto Solid Joists											
	Number of Fasteners								Characteristic Capacities [kN]			
	Header				Joist		Safe Working Loads [kN]			R <sub>1,k</sub>		R <sub>2,k</sub>
	Top Qty	Type	Face Qty	Type	Qty	Type	R <sub>1, SWL, Long Term</sub>	R <sub>2, SWL, Short Term</sub>	C16	LVL		
HB	6	N3.75x75	16	N3.75x75	10	N3.75x75	16.9	26.4	6.9	40.7	40.7	13.1

### HB onto Timber Nailers (38-74mm)

References	HB onto Timber Nailers 38-74 mm									
	Number of Fasteners					Safe Working Loads [kN]			Characteristic Capacities [kN]	
	Header				Joist		R <sub>1,SWL,Long Term</sub>	R <sub>2,SWL,Short Term</sub>	R <sub>1,k</sub>	R <sub>2,k</sub>
	Top Qty	Type	Face Qty	Type	Qty	Type	N3.75x30	N3.75x30	N3.75x30	N3.75x30
HB	6	N3.75x30	4	N3.75x30	10	N3.75x30	8.4	1.8	20.2	3.5

### HB onto Timber Nailer (75-100mm)

References	HB onto Timber Nailers 75-100 mm									
	Number of Fasteners					Safe Working Loads [kN]			Characteristic Capacities [kN]	
	Header				Joist		R <sub>1,SWL,Long Term</sub>	R <sub>2,SWL,Short Term</sub>	R <sub>1,k</sub>	R <sub>2,k</sub>
	Top Qty	Type	Face Qty	Type	Qty	Type	N3.75x75	N3.75x75	N3.75x75	N3.75x75
HB	6	N3.75x75	12	N3.75x75	10	N3.75x30	14.6	4.4	35.1	8.8

### HB Skew & Slope Adjustment Factors

References	HB Skew & Slope Adjustable Factors				
	Sloped Down	Sloped Up	Skewed	Sloped Down & Skewed	Sloped Up & Skewed
HB	0.9	0.7	0.96	0.59	0.7

HB  
**Top Flange Engineered Joist Hanger**

Winchester Road Cardinal Point Tamworth Staffordshire  
B78 3HG  
tel: +44 1827 255600  
fax: +44 1827 255616

Copyright by Simpson Strong-Tie®  
Information presented on this document is the exclusive property of Simpson Strong-Tie®  
It is valid only when associated with products supplied by Simpson Strong-Tie®

HB  
**Top Flange Engineered Joist  
Hanger**



[www.strongtie.co.uk](http://www.strongtie.co.uk)