

PEB

Plasterboard Edge Bead

Plastering and rendering made simple.

- *Products simply fixed with plaster dabs or nails.*
- *Edges, arrises, corners, joints and abutments all easier to form.*
- *Designed to minimise potential chipping, cracking and associated damage.*

Plasterboard edge bead (25mm Wing)

- *Provides reinforcement for plasterboard edges.*
- *Suitable for 9.5mm or 12.5mm plasterboard.*

Installation

Edge beads may be fixed by dabs or by masonry nails of similar material.

Plasterboard Edge Bead: Fix the perforated wing flush to the board face before applying final skim coat. The bead may be reversed if required by fixing the wing to the board's inner surface.

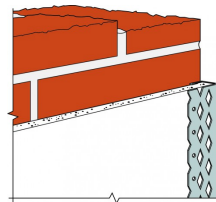
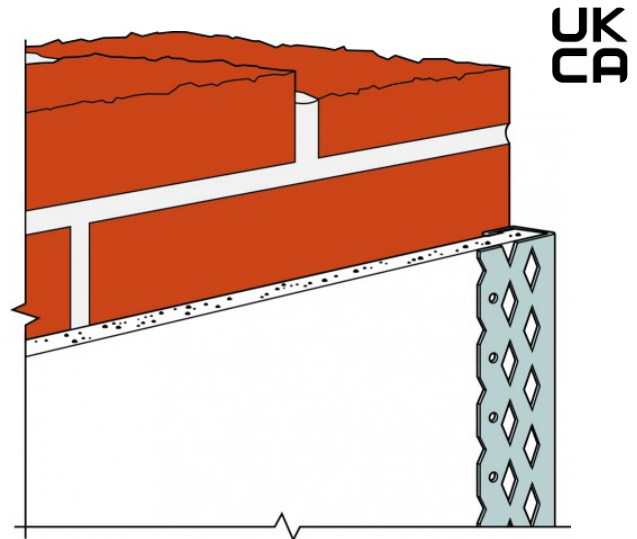

PEB
Plasterboard Edge Bead

Technical Data

PEB Product Dimensions

References	Material	Dimensions
PEB1030	Galvanised	9.5mm x 3.0m
PEB1330	Galvanised	12.5mm x 3.0m
PEB1530	Galvanised	14.5mm x 3.0m

Winchester Road Cardinal Point Tamworth Staffordshire B78 3HG
tel: +44 1827 255600
fax: +44 1827 255616

PEB
Plasterboard Edge Bead

