

MMB Mini Mesh Bead

Mini Mesh Bead (25mm wing, 3mm plaster depth)

- *Designed for use with one coat plaster work down to a 3mm finish.*
- *Fine mesh wings to provide an excellent plastering key.*

Installation:

Installation usually achieved by pressing the wings firmly into plaster dabs placed at approximately 600mm centres both sides of the arris. The wings may alternatively be embedded into the first coat of plaster for normal two-coat work.

Beads may be cut to size as required by using a hacksaw and snips. Beads should be stored off the ground and in dry conditions during site work.

CE
UK
CA

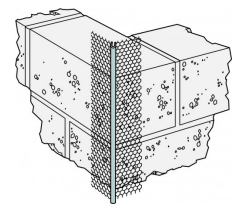

MMB
Mini Mesh Bead

Technical Data

MMB Dimensions

References	Material	Length [m]
MMB24	Galvanised	2.4m
MMB30	Galvanised	3.0m

Winchester Road Cardinal Point Tamworth Staffordshire B78 3HG
tel: +44 1827 255600
fax: +44 1827 255616

MMB
Mini Mesh Bead

