

## BTS Brick to Timber Tie

*The BTS wall ties are used to restrain external brickwork back to timber frame building structures.*

*The BTS offers an outstanding combination of performance and cost in a wall tie for use with timber frame.*

*Allows up to 24mm of differential movement.*

## Features

### Material

- Austenitic stainless steel

CE  
UK  
CA

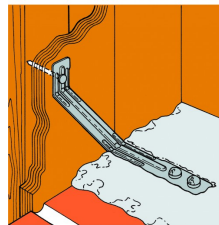

NSS3.35x50mm  
Nail Supplied with BTS.

BTS  
Brick to Timber Tie

## Technical Data

### BTS Product Dimensions

References	Application	Type Classification	Cavity Width [mm]	B [mm]	Declared Compressive Load Capacity [N]	Declared Tensile Load Capacity [N]
BTS50N	Timber Frame Cavity Wall Tie	Type 6	50	124	440	630
BTS75N	Timber Frame Cavity Wall Tie	Type 6	75	149	440	630
BTS100N	Timber Frame Cavity Wall Tie	Type 6	100	174	440	630

BTS Installed with 3.35x50mm Stainless steel annular ring shank nail (supplied with tie)

