

EFIXR
Adjustable Angle Bracket

EFIXR angle brackets are intended for all assemblies for the design and installation of interior and exterior joinery. EFIXR stiffener improves rigidity particularly for large models.

Features

Material

- Galvanized steel S250GD + Z275 according to NF EN 10346.

Benefits

- The 2 obround holes make adjustments easier.

Applications

Header member

- Supporting member type:** wood, concrete, metal, PVC.
- Supported member type:** wood, concrete, metal, PVC.

For Use With

- Frames.
- Storage cabinets.

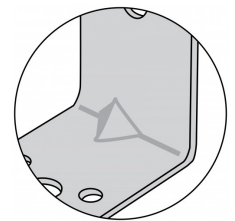
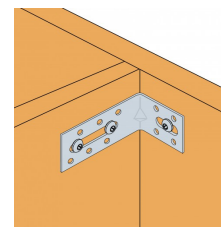
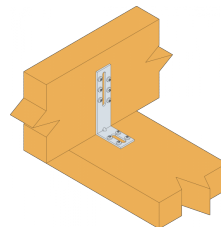
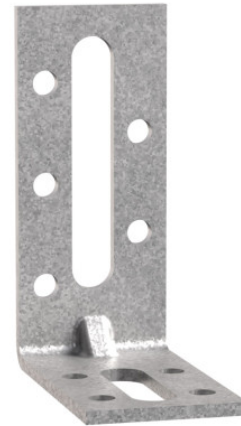

Reinforcing radius in bend

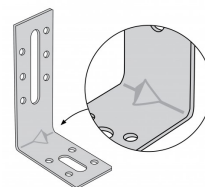

EFIXR
Adjustable Angle Bracket

Technical Data

Dimensions and drill holes

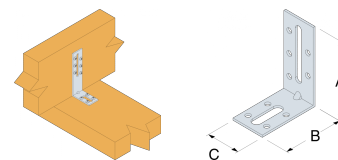

References	Product Dimensions [mm]				Holes Flange A						Holes Flange B	
	A	B	C	t	Ø5	Ø6.5x30	Ø6.5x45	Ø6.5x50	Ø6.5x55	Ø6.5x65	Ø5	Ø8,5x30
EFIXR553C50	50	54	30	2	4	1	-	-	-	-	4	1
EFIXR753C50	70	54	30	2	5	-	-	1	-	-	4	1
EFIXR1053C50	100	54	30	2.5	6	-	-	-	-	1	4	1
EFIXR1253C50	120	54	30	3	6	-	-	-	-	1	4	1

EFIXR

Adjustable Angle Bracket

Installation

Fixing

Nail holes dia. 5 mm and obround holes width 8.5 and 6.5 mm.

On wood:

- CNA annular ring-shank nails 4.0 mm.
- Bolts.
- LAG screws.
- CSA screws dia. 5.0 mm.

On concrete:

- HIPC 8-60/20 drive anchors.

On metal:

- Bolts.
- Self-drilling screws.

Installation

1. Approcher l'élément à fixer du support,
2. Pointer l'élément. Celui-ci peut aussi être vissé à l'aide de vis adaptées,
3. Si le support est en bois, l'équerre est aussi pointée ou vissée sur celui-ci,
4. Si le support est en béton, fixer l'équerre en respectant les préconisations de pose de l'ancrage choisi.

