

## LMAS A4 Threaded Rod

*Stainless steel threaded rods LMAS are intended to be used in addition to sealants chemical-GP Poly, Poly-GPG-HP and AT SET-XP. The stainless steel finish is recommended when the fasteners are used in service class 3 (outdoor, aggressive environment, etc ...)*

### Features

#### Material

**M8 to M24, A4 stainless steel.**

#### Features & Benefits

- marking for an optimum positioning
- Available diameters : M8 to M24
- High corrosion resistance

### Applications

#### Header member

**Uncracked concrete.**

#### Scope

- Universal mounting in concrete and hard natural stone.
- Fixing racks, machinery and railings.



LMAS A4  
Threaded Rod

## Technical Data

### Product Dimensions

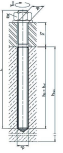

References	Article Number	Ø Thread	Ø hole x depth [d0 x h1] [mm]	Max. Fixture Thickness [tfix] [mm]	Ø max. fixture hole [df] [mm]	Anchorage depth [hef] [mm]	Total length [L] [mm]	Anchoring base material	Packaging [Cdt] [pce]
LMAS M8-95/20 A4	LMAS0810064020A4	8	-	20	9	-	95	Beton	20
LMAS M10-120/25 A4	LMAS1012080025A4	10	-	25	12	-	120	Beton	20
LMAS M10-155/60 A4	LMAS1012080060A4	10	-	60	12	-	155	Beton	20
LMAS M12-150/35 A4	LMAS1214096035A4	12	-	35	14	-	150	Beton	20
LMAS M12-185/70 A4	LMAS1214096070A4	12	-	70	14	-	185	Beton	20
LMAS M16-170/20 A4	LMAS1618128020A4	16	-	20	18	-	170	Beton	10
LMAS M16-200/50 A4	LMAS1618128050A4	16	-	50	18	-	200	Beton	10

## LMAS A4 Threaded Rod

### Installation

#### Installation

- The threaded rod can support loads once the resin has cured.
- The strength of the connection rod /mortar/concrete depends on the how clean the hole is.

