

Technical data sheet

SIMPSON

Strong-Tie

X12

Self-Drilling Screws

The X12 is a self-drilling screw with a drill point and 5/16" hex washer head. The drill point allows the screw to penetrate the steel without the need for a pilot hole.

The X1214 screws have 14 TPI and a #3 drill point capable of drilling through steel up to 5mm thick. Suitable for connecting LGS sections together. The X1224 screws have 24 TPI and a #5 drill point capable of drilling through steel up to 12.5mm thick. Used for connecting LGS sections to hot rolled steel. Driver bit not included.

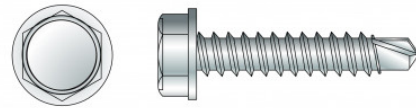

X1212D325 - LGS to LGS X1224D540 - LGS to Rolled Steel

Features

Material

Steel - Ruspert 500 coating

Features

- 5/16" hex washer head
- Drill point
- X1214 suitable for 450 grade hardened steel up to 5mm thick
- X1224 suitable for hot rolled steel sections up to 12.5mm thick
- CE marked to EN14566

Applications

Common Applications

X1214 screws connect steel section to steel section without the need for pre drilling

X1224 screws connect LGS sections to hot rolled steel without the need for pre drilling

X12 Self-Drilling Screws

Technical Data

Product Dimensions

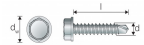

References	Fastener Dimensions [mm] [mm]				TPI	Drill Point	Box Quantity
	Head	d _w	d	l			
X1214D325	5/16" Hex	12.2	5.5	25	14	#3	250
X1214D350	5/16" Hex		5.5	50	14	#3	250
X1224D540	5/16" Hex		5.5	40	24	#5	250

Performance Values

References	Fastener Performance					
	Safe Working Loads [kN]			Characteristic Loads [kN]		
	Tension	Shear	Torsional [Nm]	Tension	Shear	Torsional [Nm]
X1214D325	4.1	2.8	3.3	6.5	4.5	5.3
X1214D350	4.1	2.8	3.3	6.5	4.5	5.3
X1224D540	4.1	2.8	3.3	6.5	4.5	5.3

Pull-Out Performance Values

References	Pull-Out Performance Values / Support Thickness [mm]													
	Safe Working Loads [kN]							Characteristic Loads [kN]						
	1.2	1.5	2	3	4	5	6	1.2	1.5	2	3	4	5	6
X1214D325	0.8	0.9	1.2	2.1	2.6	3.3	4.1	1.2	1.4	1.8	3.4	4.2	5.2	6.5
X1214D350	0.8	0.9	1.2	2.1	2.6	3.3	4.1	1.2	1.4	1.8	3.4	4.2	5.2	6.5
X1224D540	0.6	0.8	1	2	2.3	2.9	3.6	1	1.2	1.5	3.2	3.6	4.6	5.8

- 1) Steel thickness <4.0mm BS EN10025-S355, minimum yield strength 355N/mm²
- 2) Steel thickness ≥4.0mm BS EN10025-S275, minimum yield strength 275N/mm²
- 3) Pull out is limited by tensile strength of the fastener

