

GPC Gable Panel Connector

The GPC is a connector that forms part of a mechanism that provides lateral restraint to the gable wall by the roof structure.

The connectors have been developed to safely transfer lateral wind loads from the gable end into the braced roof diaphragm, giving installation options onto a continuous wall plate.

Available in sizes to suit 100mm, 115mm and 140mm masonry walls.

- Easy & quick to install with no masonry fasteners required
- Sits directly on the top of the top layer of blockwork

NEW

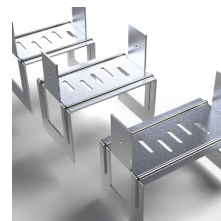
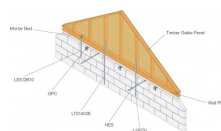
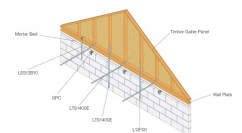
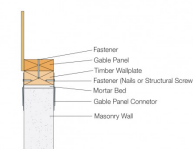
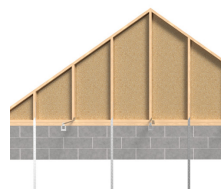
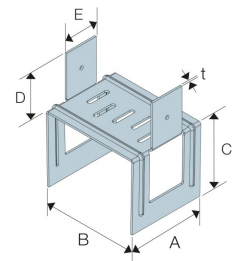

GPC
Gable Panel Connector

Technical Data

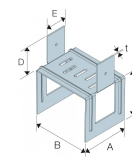

Product Dimensions

References	Connector Dimensions [mm]						Fixing Holes
	A	B	C	D	E	t	Wall Plate
							Ø4.1mm
GPC100	80	100	75	50	35	2	2
GPC115	80	115	75	50	35	2	2
GPC140	80	140	75	50	35	2	2

Product Characteristics

References	Fasteners		Performance Values	
	Wall Plate		Characteristic Capacities	Safe Working Loads [kN]
	Qty	Type	$R_{3,k}=R_{4,k}$	$R_3=R_{4,SWL}$, Long Term
GPC100	2	N3.75x30 Nails or CSA4.0x30 Screws	4.2	2.8
GPC115	2	N3.75x30 Nails or CSA4.0x30 Screws	4.2	2.8
GPC140	2	N3.75x30 Nails or CSA4.0x30 Screws	4.2	2.8

GPC Gable Panel Connector

Installation

Installation

- Suitable for use on Continuous Wall Plate and Raised Wall Plate Installations.
- Install directly onto the top block, dry bedded & spaced to provide 2kN/m lateral capacity
- Lay mortar between GPC & wall plate to allow the wall plate to be levelled.
- Fix the connector to the wall plate using 2 No 3.75x30mm square Twist Nails, or 2 No 4.0x30mm Wood Screws (SIMPSON Strong-Tie CSA4.0x30mm or equivalent)
- Fix the bottom rail of the Timber Gable Panel to the wall plate with either structural screws or nails, ensuring fasteners achieve minimum lateral capacity of 2kN/m.
- Connection details between the gable panel and wallplate are to be designed by the building designer ensuring required loads are transferred between the timber gable panel and the wallplate.
- To hold the timber gable panel down onto the supporting masonry wall either LES10B10, LTS1400E or L12F00 should be used.
- For the transfer of wind loads from the gable wall (timber gable panel and/or masonry) to the roof structure either LTS1400E or HES15B10 lateral restraint straps should be used.
- The quantity and installation centres for the GPC, lateral restraint straps and hold down straps should be specified by the building designer or structural engineer.
- Meets the minimum requirement of Building Regulations 2010 approved document A, Scottish Building Regulations domestic, NHBC Standards for houses of 3 storeys or less - England and Wales and 2 storeys or less - Scotland.

Continuous Wallplate Installation

Lateral Restraint Connectors:

- GPC: Gable Panel Connector, and
- LTS1400E: Vertical restraint Strap

Vertical Restraint Connectors:

- LES: Light Engineered Hold Down Strap, or
- LTS1400E: Vertical restraint Strap, or
- L12F00: Flat Strap

Raised Wallplate Installation

Lateral Restraint Connectors:

- GPC: Gable Panel Connector, and
- HES: Horizontal Restraint Strap

Vertical Restraint Connectors:

- LES: Light Engineered Hold Down Strap, or
- LTS1400E: Vertical restraint Strap, or
- L12F00: Flat Strap

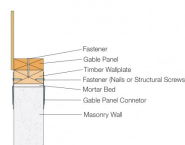
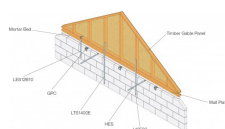
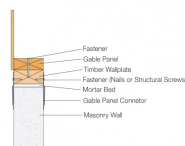
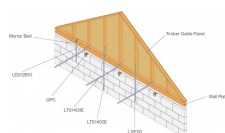



GPC
Gable Panel Connector

Winchester Road Cardinal Point Tamworth Staffordshire B78 3HG
tel: +44 1827 255600
fax: +44 1827 255616

GPC
Gable Panel Connector



Copyright by Simpson Strong-Tie®
Information presented on this document is the exclusive property of Simpson Strong-Tie®
It is valid only when associated with products supplied by Simpson Strong-Tie®

2024-02-17

www.strongtie.co.uk