

NPB255

Nail plate for CLT

The NPB255 nail plate have been designed especially for CLT building. Flexible, the installation is helped by a line that indicate where to place the plate.

Features

Materiál

Kvalita oceli:

- S 250 GD+Z 275 dle norem DIN EN

Ochrana proti korozi:

- **275 g/m pozinkováno z obou stran cca 20mm**

Vorteile

- Ideal for CLT building
- Easy installation with the line on it
- Can be used on timber and concrete support
- High capacity

Applications

Anwendungsbereich

- Velmi užitečné napínátko pro zavětrovací pásy o rozměrech 40x2,0mm.
- Mohou být použity k 60mm široké zavětrovací pásce, ale pro tento rozměr doporučujeme BANSTRS.
- Zavětrovací páska musí být přichycena hřebíky

Domaine d'utilisation

*

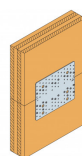
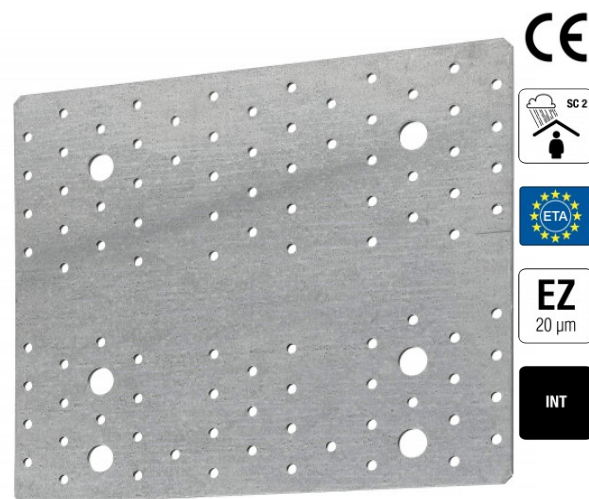

Wood to wood

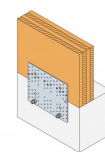

Wood to concrete



Fixation bois sur béton



NPB255
Nail plate for CLT

Technical Data

Rozměry a typické hodnoty

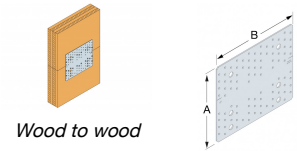

Art. nr.	Rozměry [mm]			Otvory	
	A	B	Tloušťka	Ø5	Ø14
NPB255	214	255	3	93	6
NPB255S0	294	255	3	97	6

Connection timber to timber

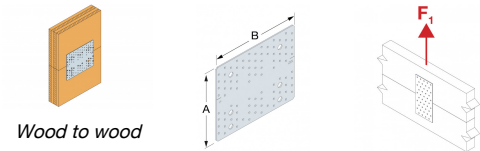

Art. nr.	Product capacities - Timber to timber or CLT to CLT					
	Upevňovací prvky		Charakteristické kapacity - dřevo C24 [kN]			
	Top part	Bottom part	R _{1,k}		R _{2,k}	
			CNA4.0x50	CSA5.0x50	CNA4.0x50	CSA5.0x50
NPB255 NP 1	11	15	23.9	27.6	20.8	24
NPB255 NP 2	13	15	28.3	32.6	19.4	22.3
NPB255 NP 3	30	31	66.5	78.9	33.9	40.2
NPB255 NP 4	24	28	53.2	63.1	27.7	32.9
NPB255S0 NP 5	30	31	66.5	78.9	25	29.7

The connection for timber can also be apply for CLT connection. The distances to the border have to considered in relation to the direction of fibre.

The nail pattern NP 1 to 5 are described in the pdf document available in the installation tab.

NPB255
Nail plate for CLT

Connection timber to rigid support

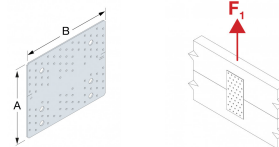

Art. nr.	Product capacities - timber or CLT to Rigid support						
	Fasteners		Product characteristic capacities - Timber C24 [kN]				f [mm]
	Top part	Bottom part	R _{1,k}		R _{2,k}		
			CNA4.0x50	CSA5.0x50	CNA4.0x50	CSA5.0x50	
NPB255 NP 6	11	2	23.9	27.6	22.8	26.3	115
NPB255 NP 7	13	2	min (37,1 /kmod ; 28,9)	min (37,1 /kmod ; 34,2)	min (21,1 /kmod ; 19,3)	min (21,1 /kmod ; 22,9)	120
NPB255 NP 8	30	2	min (37,1 /kmod ; 66,6)	min (37,1 /kmod ; 78,9)	min (27,8 /kmod ; 28,4)	min (27,8 /kmod ; 33,7)	70
NPB255 NP 9	19	2	min (37,1 /kmod ; 42,2)	min (37,1 /kmod ; 50,0)	min (21,1 /kmod ; 24,0)	min (21,1 /kmod ; 28,4)	100
NPB255SO NP 10	24	2	min (37,1 /kmod ; 52,2)	min (37,1 /kmod ; 60,2)	22.2	25.6	120
NPB255SO NP 11	26	2	min (37,1 /kmod ; 56,6)	min (37,1 /kmod ; 65,3)	21.5	24.8	120
NPB255SO NP 12	30	2	min (37,1 /kmod ; 66,6)	min (37,1 /kmod ; 78,9)	min (27,8 /kmod ; 21,3)	min (27,8 /kmod ; 25,2)	115
NPB255SO NP 13	30	2	min (37,1 /kmod ; 66,6)	min (37,1 /kmod ; 78,9)	min (23,2 /kmod ; 25,5)	min (23,1 /kmod ; 30,2)	100

The connection for timber can also be apply for CLT connection. The distances to the border have to considered in relation to the direction of fibre. The connection to concrete has to be check for the anchors and the distances.

The anchorage of the bolts M12 has to check with the relavant distances.

The force F_2 has to considered with the lever arm "f" , which is given in the table. Ist also to find in the dpf with the nailing pattern.

The nail pattern NP 6 to 13 are described in the pdf document given first line on the installation tab.

NPB255
Nail plate for CLT

Installation

Befestigung

On timber:

- CNA 4.0x50 on timber
- CSA 5.0x40 or CSA 5.0x50 screws

On concrete:

- Mechanical anchor: WA M12-104/5
- Chemical anchor: AT-HP resin + LMAS M12-150/35 threaded rod

Anwendungsbereich

- Velmi užitečné napínátko pro zavětrovací pásy o rozměrech 40x2,0mm.
- Mohou být použity k 60mm široké zavětrovací pásce, ale pro tento rozměr doporučujeme BANSTRS.
- Zavětrovací páska musí být přichycena hřebíky

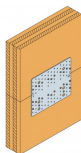

Wood to wood

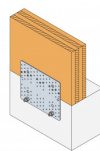

Wood to concrete

NPB255
Nail plate for CLT

