

## Technický list

**SIMPSON**

**Strong-Tie**

HDCLT

### **Concealed solution for connecting CLT walls to concrete foundations.**

High strength, low profile, seamlessly secure. Designed specifically for connecting cross-laminated timber (CLT) wall panels to concrete foundations: the HDCLT tension tie provides a robust design uplift capacity of up to 18.6 kN, yet due to its low profile of just 140 mm, remains completely concealed within the subfloor and floor covering layers.

To help reduce installation time, the fastener configuration has been optimised for maximum performance with the most efficient screw quantity.

HDCLT includes an 8mm thick washer integrated with the tension tie seat, which provides additional strength where it is most needed. The profile design permits up to 25mm concrete-CLT panel interlayer thickness.



## Applications

### Material

**Tension Tie: S 250 GD + Z 275 according to DIN EN**

**Washer: S235JR according to EN 10025**

### **Corrosion Protection:**

**275 g/m2 galvanized on both sides 20mm washer: ~ 55µm according to EN1461**

### Suitable For

#### **Supporting Member:**

- CLT, Concrete, Steel, Solid Timber

#### **Supported Member:**

- CLT, Solid wood, Engineered Timber

### Fastener

- CSA Ø5mm or CNAØ4mm according to ETA-04/0013
- On concrete: Heavy Duty Wedge Anchor, Injection system for concrete, High capacity undercut anchor, concrete screw

### Installation

**The connection to the wood is made with CNA nails or CSA connector screws.**

**The bolt must be verified for the tensile force to be absorbed.**

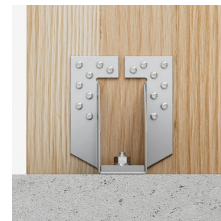

HDCLT

**Concealed solution for connecting CLT walls to concrete foundations.**

## Technical Data

Product dimensions

Table "Product dimensions" cannot be displayed : no references available.

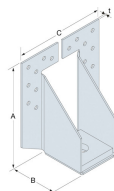

Product capacities

Table "Product capacities" cannot be displayed : no references available.

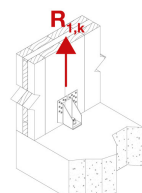
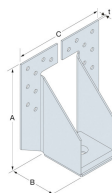

Product capacities [kser]

Table "Product capacities [kser]" cannot be displayed : no references available.

HDCLT

**Concealed solution for connecting CLT walls to concrete foundations.**

