

Technický list



CCS
Cylindrical connector series

CCS connectors are designed for timber to timber or timber to steel connections. They are designed for axial and shear load. They can be connected to the timber with 4, 6 or 8 CSFT-screws.

Features

Material

Steel

Benefits

Super flexible application possibilities
Connections: timber to timber or timber to steel
Designed for vertical (F1) and horizontal (F2/F3) force directions

Applications

Suitable On

Supporting member: solid wood
Supported member: solid wood

When to Use

Timber to timber
Timber to steel

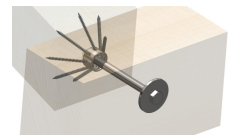
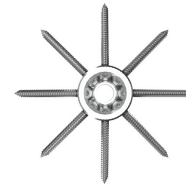

CCS
Cylindrical connector series

Technical Data

Product Dimensions

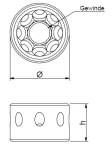

Art. nr.	Ø [mm]	h [mm]	Holes		Thread Ø
			units	Ø [mm]	
CCS30/70	30	25	8	5.2	M12
CCS40/85	40	25	8	6.5	M16
CCS40/110	40	25	8	6.5	M16
CCS50/85	50	25	8	6.5	M20
CCS50/110	50	25	8	6.5	M20

Installation dimensions - screwing pattern 1

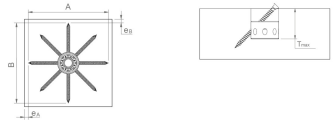

Art. nr.	Screwing pattern 1 - Installation dimensions								
	CSFT-screws		Product information						
	number [n]	dimensions [Ø x l]	A	Overhang to the edge [e _A]	B	Overhang to the edge [e _B]	H	Overhang to the edge [e _H]	drilling depth [T _{max}]
CCS30/70	8	5.0x70	120	7	120	7	61	3	32
CCS40/85	8	6.0x85	147	11	147	11	68	5	42
CCS40/110	8	6.0x110	182	15	182	15	85	7	42
CCS50/85	8	6.0x85	153	10	153	10	66	5	52
CCS50/110	8	6.0x110	188	13	188	13	83	7	52

Installation dimensions - screwing pattern 2

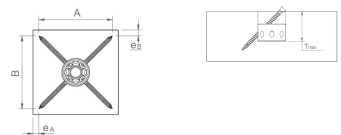

Art. nr.	Screwing pattern 2 - Installation dimensions								
	CSFT-screws		Product information						
	number [n]	dimensions [Ø x l]	A	Overhang to the edge [e _A]	B	Overhang to the edge [e _B]	H	Overhang to the edge [e _H]	drilling depth [T _{max}]
CCS30/70	4	5.0x70	85	7	85	7	61	3	32
CCS40/85	4	6.0x85	104	11	104	11	68	5	42
CCS40/110	4	6.0x110	129	14	129	14	85	7	42
CCS50/85	4	6.0x85	108	10	108	10	66	5	52
CCS50/110	4	6.0x110	133	12	133	12	83	7	52

CCS
Cylindrical connector series

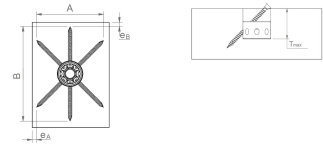

Installation dimensions - - screwing pattern 3

Art. nr.	Screwing pattern 3 - Installation dimensions								
	CSFT-screws		Product information						
	number [n]	dimensions [\emptyset x l]	A	Overhang to the edge [e_A]	B	Overhang to the edge [e_B]	H	Overhang to the edge [e_H]	drilling depth [T_{max}]
CCS30/70	6	5.0x70	85	7	120	7	61	3	32
CCS40/85	6	6.0x85	104	11	147	11	68	5	42
CCS40/110	6	6.0x110	129	14	182	15	85	7	42
CCS50/85	6	6.0x85	108	10	153	10	66	5	52
CCS50/110	6	6.0x110	133	12	188	12	83	7	52

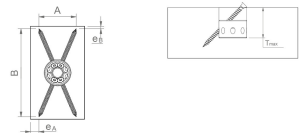

Installation dimensions - screwing pattern 4

Art. nr.	Screwing pattern 4 - Installation dimensions								
	CSFT-screws		Product information						
	number [n]	dimension [\emptyset x l]	A	Overhang to the edge [e_A]	B	Overhang to the edge [e_B]	H	Overhang to the edge [e_H]	drilling depth [T_{max}]
CCS30/70	4	5.0x70	46	4	111	9	61	3	32
CCS40/85	4	6.0x85	56	6	136	14	68	5	42
CCS40/110	4	6.0x110	70	8	168	18	85	7	42
CCS50/85	4	6.0x85	59	5	141	11	66	5	52
CCS50/110	4	6.0x110	72	7	174	16	83	7	52

CCS
Cylindrical connector series

Installation

Fasteners

On timber:
4, 6 oder 8 CSFT-screws

On steel:
Bolt or threaded rod

Installation

Material: S355JR
Corrosion protection: galvanized

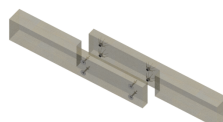
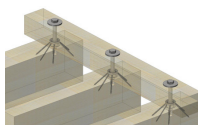
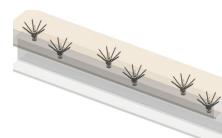
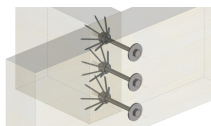

CCS
Cylindrical connector series

