

TAN

### Selfdrilling Nylon Plug for Plasterboard

The TAN nylon plug is designed for fastening in plasterboard. The dowel is screwed into single and double planked board elements with a positive fit and flush with the surface. The fastening elements to be connected can be mounted with wood, -/ sheet metal / chipboard - screws from Ø3.0 mm to Ø4.5 mm.

## Features

### Benefits

- No pilot hole required
- Also suitable for double plasterboard panels

## Applications

### Material

- Nylon

### Applications

- Wooden battens
- Curtain track
- Metal profiles

### Suitable for

- Plasterboard

**NEW**

## TAN Selfdrilling Nylon Plug for Plasterboard

### Technical Data

#### Product Dimensions

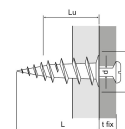

Art. nr.	Product Reference	Dimensions [ØxL] [mm]	Min. screw diameter [d] [mm]	Max. screw diameter [d] [mm]	Washer diameter $d_r$ [mm]	Min. thread engagement [ $L_u$ ] [mm]	Qty per box	Qty per outer box
6550501503500	TAN	Ø6.5x35	3	4.5	14	22	100	1000

Screw Length:  $L_v = L_u + t_{fix}$

Use Phillips PH2 insert with plasterboard plug

TAN

Selfdrilling Nylon Plug for Plasterboard

Installation

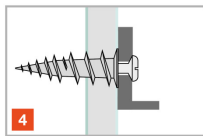
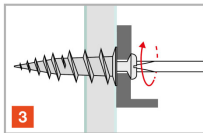
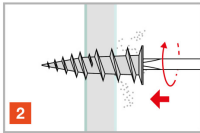
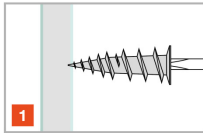

TAN

Selfdrilling Nylon Plug for Plasterboard

