

Technický list

SIMPSON

Strong-Tie

TU Plug Nylon/Polypropylene Plug

The TU nylon plug is a versatile fixing solution for light applications in solid and hollow building materials.

Features

Material

- Nylon

Benefits

- Suitable for most light fixing applications
- Anti-rotation wings
- Maximum expansion

Applications

Applications

- Wooden battens
- Light internal furnishings
- Signs

Suitable for

- Non-cracked concrete
- Solid brick
- Honeycomb brick (partially suitable)
- Cell like clay brick (partially suitable)
- Lightweight honeycomb brick (partially suitable)
- Hollow dense aggregate block (partially suitable)
- Hollow light aggregate block (partially suitable)
- Aerated concrete
- Solid stone

NEW

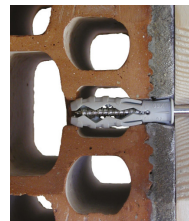

TU Plug
Nylon/Polypropylene Plug

Technical Data

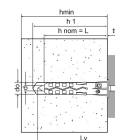

Product Dimensions Rimmed Plug

Art. nr.	Product Reference	Hole diameter x anchor length [d _o xL] [mm]	Min. hole depth [h ₁] [mm]	Nominal embedment depth [h _{nom}] [mm]	Min. support thickness [h _{min}] [mm]	Min. screw diameter [d] [mm]	Max. screw diameter [d] [mm]	Qty per box	Qty per outer box
6000100402000	TU	Ø4x20	30	20	40	2	3	300	9600
6000100502500		Ø5x25	35	25	50	2.5	4	100	3200
6000100603000		Ø6x30	40	30	60	3.5	5	100	3200
6000100703500		Ø7x35	45	35	80	4	5.5	150	2400
6000100804000		Ø8x40	55	40	80	4.5	6	100	1600
6000101005000		Ø10x50	65	50	100	6	8	50	800
6000101006000		Ø10x60	75	60	120	6	8	25	400
6000101206000		Ø12x60	75	60	120	8	10	25	400
6000101408000		Ø14x80	100	80	160	10	12	20	160
6000101608000		Ø16x80	100	80	160	12	14	15	120

TU Plug
Nylon/Polypropylene Plug

Installation

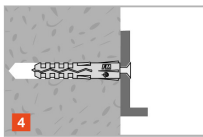
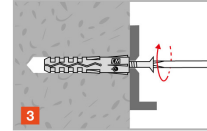
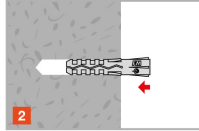
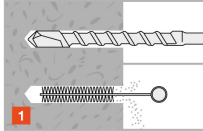

TU Plug
Nylon/Polypropylene Plug

