

TSS

Countersunk Preassembled Nylon Plug

The TSS nylon plug in Ø6 and Ø8 mm versions are approved for fastening in concrete. When the nail screw is driven into the anchor plug, it is expanded and securely anchored in the building material.

Features

Material

- Plug: grey nylon
- Screw: white zinc plated steel

Benefits

- Countersunk rim for roofing professionals
- Innovative geometry

Applications

Applications

- Wooden battens
- Electrical components
- Skirting boards

Suitable for

- Non-cracked concrete
- Solid brick
- Honeycomb brick (partially suitable)
- Cell like clay brick (partially suitable)
- Lightweight honeycomb brick (partially suitable)
- Hollow dense aggregate block (partially suitable)
- Hollow light aggregate block (partially suitable)
- Aerated concrete (partially suitable)
- Solid stone



TSS
Countersunk Preassembled Nylon Plug

Technical Data

Product Dimensions

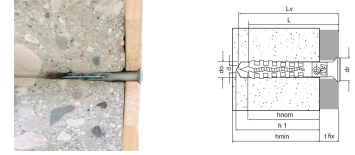

Art. nr.	Product Reference	Hole diameter x anchor length [d _o xL] [mm]	Fixture thickness [t _{fix}] [mm]	Min. hole depth [h ₁] [mm]	Nominal embedment depth [h _{nom}] [mm]	Min. support thickness [h _{min}] [mm]	Screw diameter [d] [mm]	Screw length [L _v] [mm]	Collar diameter [d _c] [mm]	Qty per box	Qty per outer box
62200B0604000	TSS	Ø6x40	10	40	30	100	3.8	45	10	200	2000
62200B0605000		Ø6x50	20	40	30	100	3.8	55	10	100	1000
62200B0606000		Ø6x60	30	40	30	100	3.8	65	10	100	1000
62200B0608000		Ø6x80	50	40	30	100	3.8	85	10	100	1000
62200B0806000		Ø8x60	20	50	40	100	4.8	65	12	150	1500
62200B0808000		Ø8x80	40	50	40	100	4.8	85	12	150	1500
62200B0810000		Ø8x100	60	50	40	100	4.8	105	12	100	1000
62200B0812000		Ø8x120	80	50	40	100	4.8	125	12	100	1000
62200B0814000		Ø8x140	100	50	40	100	4.8	145	12	100	1000

**Not covered by CE certification*

TSS
Countersunk Preassembled Nylon Plug

Installation

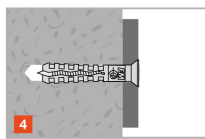
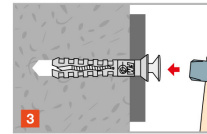
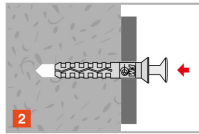
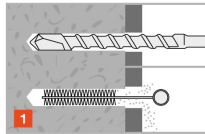

Spacing and edge distance

Art. nr.	Product Reference	Hole diameter x anchor length [d ₀ xL] [mm]	Min. edge distance [c _{min}] [mm]	Min. spacing [s _{min}] [mm]
62200B0604000	TSS	Ø6x40	100	100
62200B0605000	TSS	Ø6x50	100	100
62200B0606000	TSS	Ø6x60	100	100
62200B0608000	TSS	Ø6x80	100	100
62200B0806000	TSS	Ø8x60	100	100
62200B0808000	TSS	Ø8x80	100	100
62200B0810000	TSS	Ø8x100	100	100
62200B0812000	TSS	Ø8x120	100	100
62200B0814000	TSS	Ø8x140	100	100

* Not included in the approval

Installation data

Art. nr.	Product Reference	Hole diameter x anchor length [d ₀ xL] [mm]	Ø drilling hole [d ₀] [mm]	Min. hole depth [h ₁] [mm]	Min. support thickness [h _{min}] [mm]
62200B0604000	TSS	Ø6x40	6	40	100
62200B0605000	TSS	Ø6x50	6	40	100
62200B0606000	TSS	Ø6x60	6	40	100
62200B0608000	TSS	Ø6x80	6	40	100
62200B0806000	TSS	Ø8x60	8	50	100
62200B0808000	TSS	Ø8x80	8	50	100
62200B0810000	TSS	Ø8x100	8	50	100
62200B0812000	TSS	Ø8x120	8	50	100
62200B0814000	TSS	Ø8x140	8	50	100

Technický list

SIMPSON

Strong-Tie

TSS

Countersunk Preassembled Nylon Plug

TSS

Countersunk Preassembled Nylon Plug



SIMPSON

Strong-Tie