

SIMPSON**Strong-Tie**

Spikermønster



REV

0

REV DATE

24/10/25

DWG NAME

C_PU100_2D0_NP_B-PTRS-NO

Art. Nr.

=

PU100-B

Festemidler

=

Tre på betong/stål

Søyle til betong eller stål

Type festemiddel

=

-

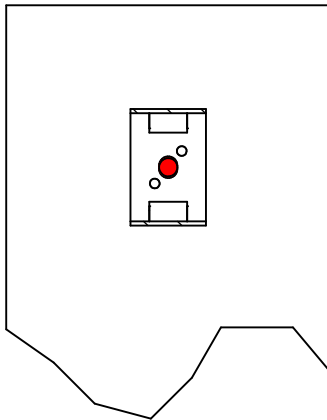
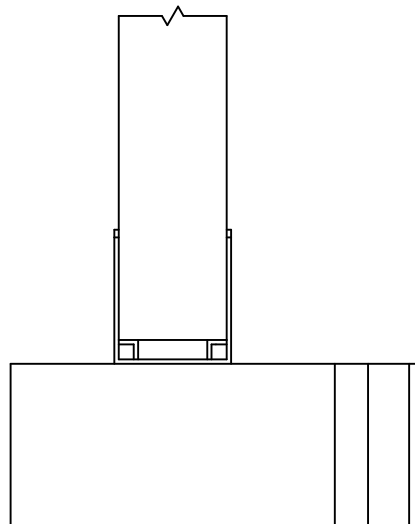
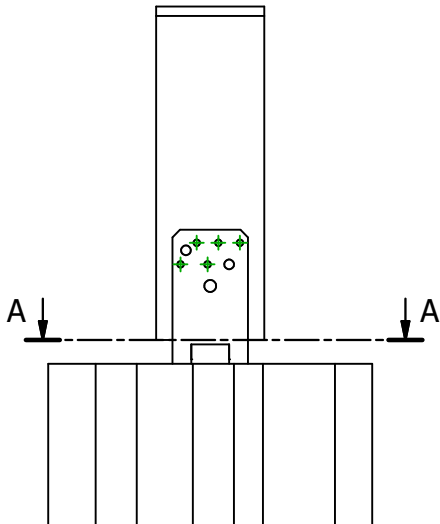

A-A (1:7)

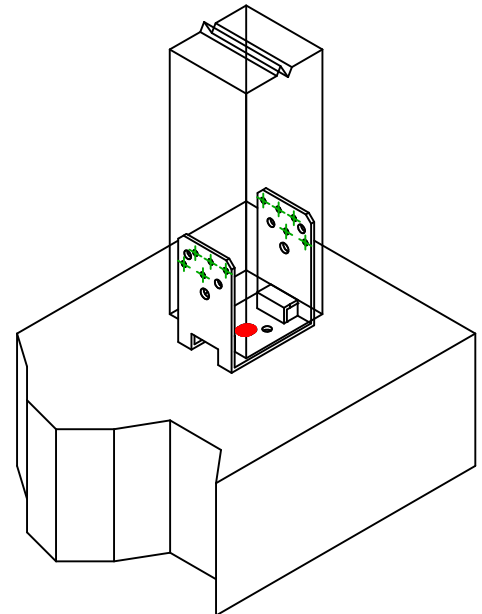

Festemidler i hovedbjelke	Symbol	Festemidler	Art. Nr.	Antall
		FM-753	FM-753 CRACK 3DG M16X150/30	1
		-	-	
		-	-	
Festemidler i sekundærbjelke	Symbol	Festemidler	Art. Nr.	Antall
		CNA	CNA4.0X50	10
		-	-	