

SIMPSON

Strong-Tie

Schemat montażu



REV

0

REV DATE

26/07/24

DWG NAME

C_SAEL380_2D0_NP_JTP-PL

Produkt

=

SAEL380

Łączniki

=

Drewno - drewno

Belka do słupa

Typ montażu





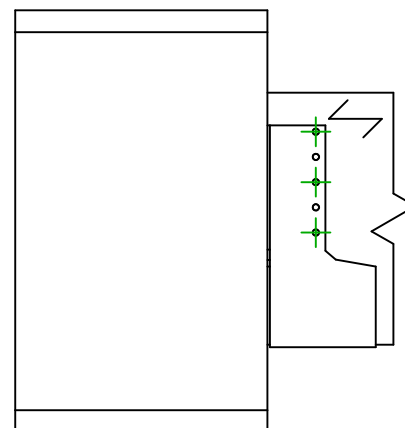
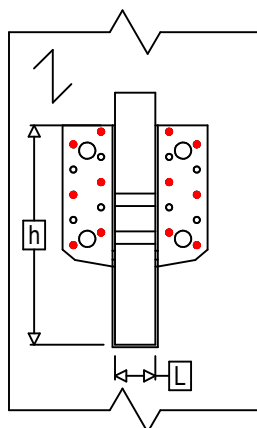
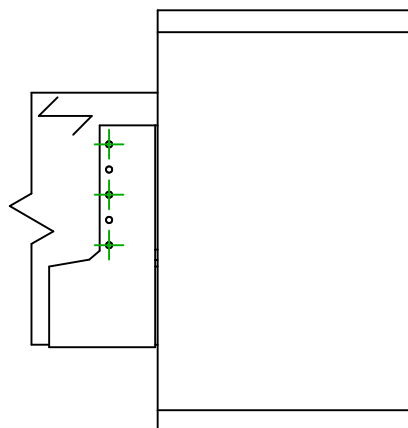



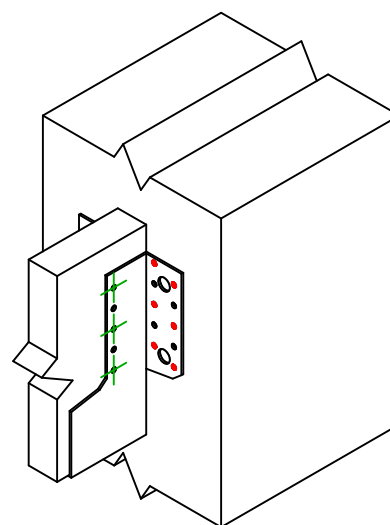

=

Częściowe gwoździowanie



$$h = (380 - L) / 2$$



Łączniki belka główna	Symbol	Łączniki	Łączniki		Szt.
		CNA  	CNA4.0X35 / CNA4.0X50		12
		CSA  	CSA5.0X35 / CSA5.0X40		
		-	-		
Łączniki belka drugorzędna	Symbol	Łączniki	L < 64mm	L > 64mm	Szt.
		CNA  	CNA4.0X35	CNA4.0X50	6
		CSA  	CSA5.0X35	CSA5.0X40	