

SIMPSON

Strong-Tie

## Schemat montażu



REV

0

REV DATE

26/07/24

DWG NAME

C\_SAE500\_2D0\_NP\_JTB-SSH-PL

Produkt

=

SAE500

Łączniki

=

Drewno - drewno

Belka - belka

Typ montażu



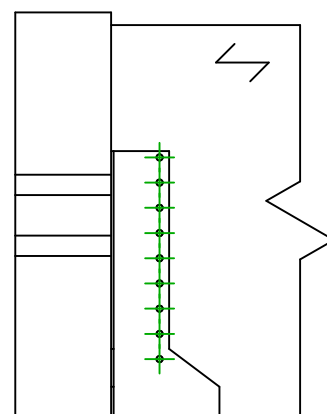
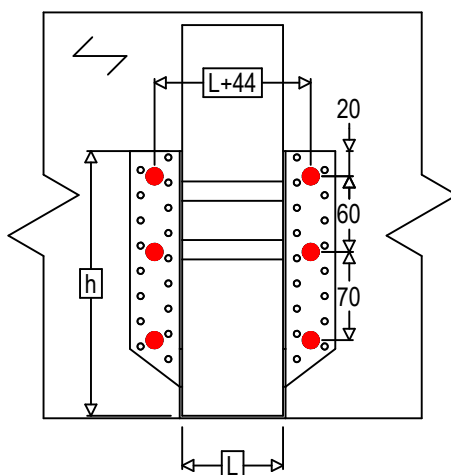
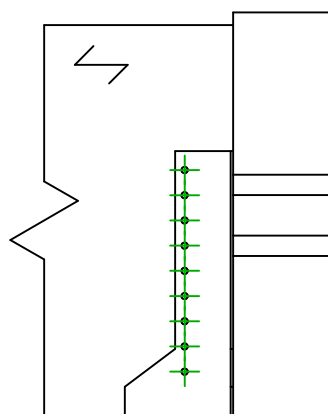

=

Montaż wkrętami SSH

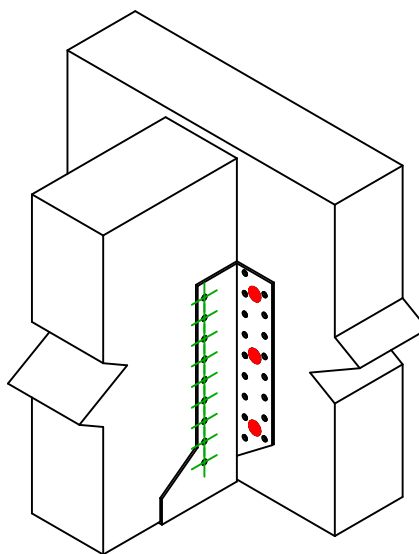

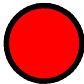
$$h = (500 - L) / 2$$



Łączniki belka główna	Symbol	Łączniki	Łączniki		Szt.
		SSH 	SSH12.0X60		6
		-	-		
		-	-		
Łączniki belka drugorzędna	Symbol	Łączniki	L < 64mm	L > 64mm	Szt.
		CNA 	CNA4.0X35	CNA4.0X50	18
		CSA 	CSA5.0X35	CSA5.0X40	