

**SIMPSON****Strong-Tie**

# Spikermønster



REV

0

REV DATE

26/07/24

DWG NAME

C\_SAE440\_2D0\_NP\_JTB-FN-NO

Art. Nr.

=

SAE440

Festemidler

=

Tre til Tre

Bjelke til bjelke

Type festemiddel





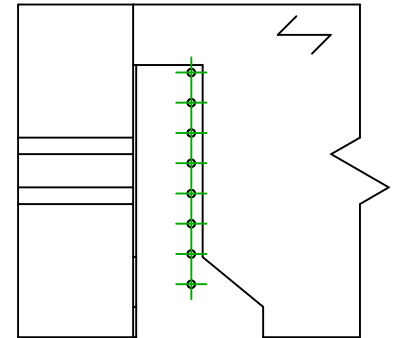
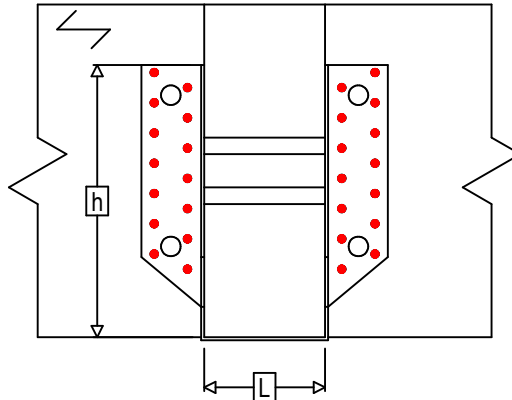
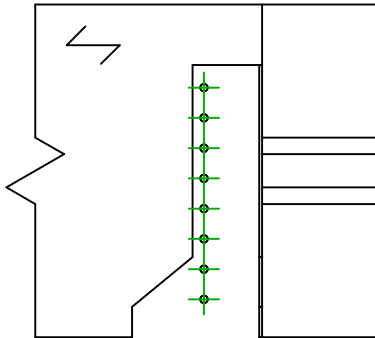



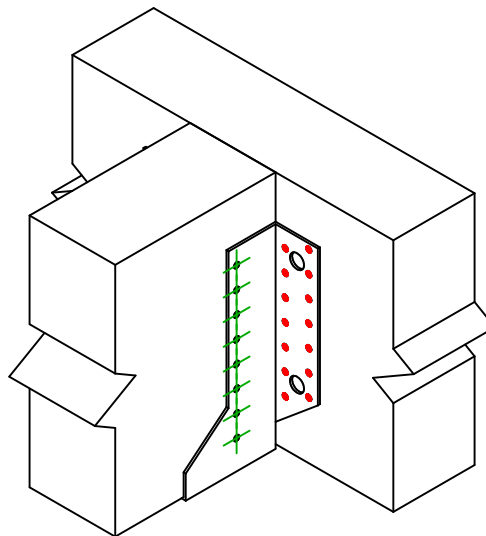

=

Full utspikring



$$h = (440 - L) / 2$$



| Festemidler i hovedbjelke    | Symbol  | Festemidler   | Festemidler           |           | Antall |
|------------------------------|---|---|-----------------------|-----------|--------|
|                              |  | CNA   | CNA4.0X35 / CNA4.0X50 |           | 28     |
|                              |   | CSA   | CSA5.0X35 / CSA5.0X40 |           |        |
|                              |   | -   | -                     |           |        |
| Festemidler i sekundærbjelke | Symbol  | Festemidler   | L < 64mm              | L > 64mm  | Antall |
|                              |  | CNA   | CNA4.0X35             | CNA4.0X50 | 16     |
|                              |   | CSA   | CSA5.0X35             | CSA5.0X40 |        |