

SIMPSON**Strong-Tie**

Schemat montażu



REV

0

REV DATE

26/07/24

DWG NAME

C_SAE380_2D0_NP_JTP-PL

Produkt

=

SAE380

Łączniki

=

Drewno - drewno

Belka do słupa

Typ montażu

=

Częściowe gwoździowanie

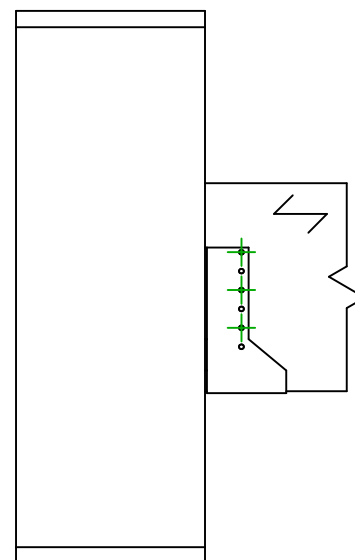
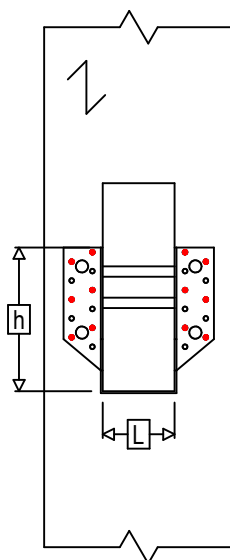
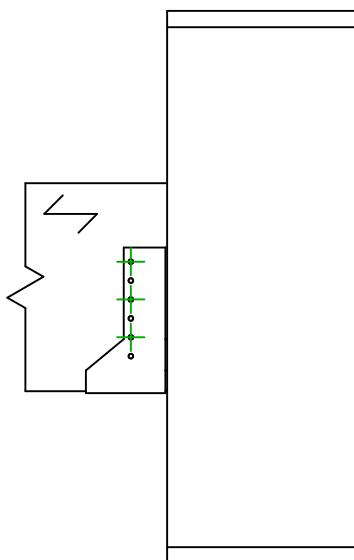

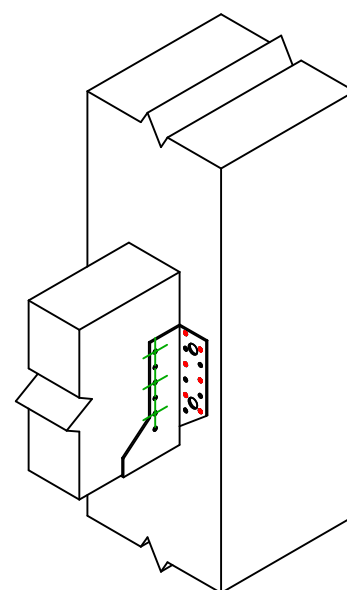

$$h = (380 - L) / 2$$

Łączniki
belka główna

Symbol

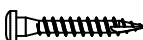

Łączniki

CNA  CSA  

-

Łączniki

CNA4.0X35 / CNA4.0X50

CSA5.0X35 / CSA5.0X40

-

Szt.

12

Łączniki
belka
drugorzędna

Symbol



Łączniki

CNA  CSA  

L < 64mm

CNA4.0X35

CSA5.0X35

L > 64mm

CNA4.0X50

CSA5.0X40

Szt.

6