

**SIMPSON****Strong-Tie**

# Spikermønster



REV

0

REV DATE

26/07/24

DWG NAME

C\_SAE250\_2D0\_NP\_JTRS-NO

Art. Nr.

=

SAE250

Festemidler

=

Tre på betong/stål

Bjelke til bjelke

Type festemiddel

=

Innfesting til fast underlag

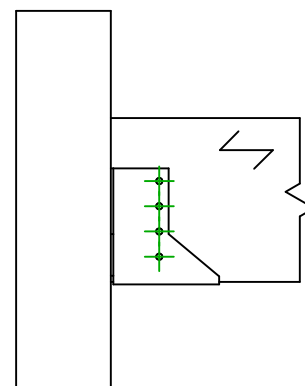
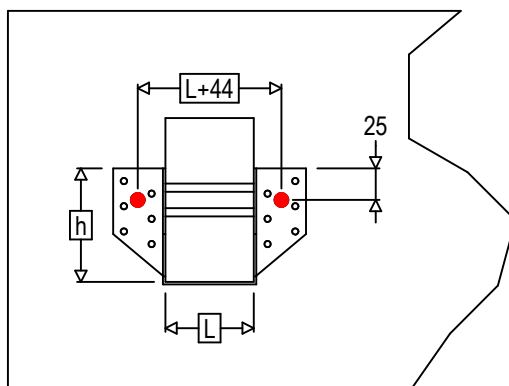
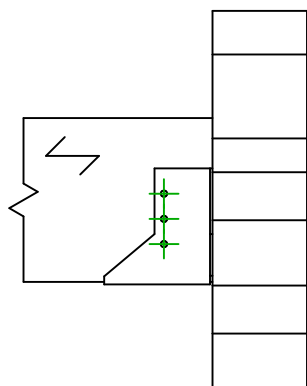

$$h = (250 - L) / 2$$

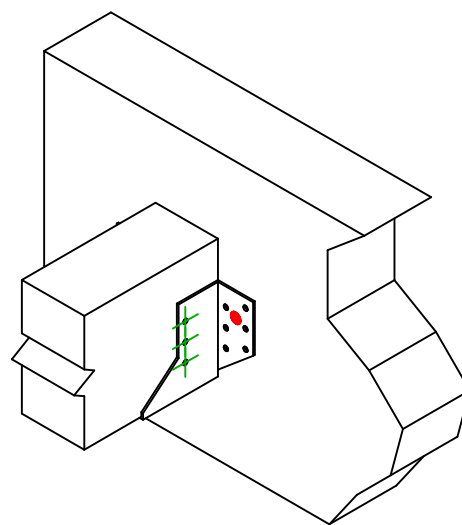
Festemidler i  
hovedbjelke

Symbol



Festemidler

FM753

LMAS

THD

Festemidler

FM 753 EVO M10X78/5

LMASM10

THD08070

Antall

2

Festemidler i  
sekundærbjelke

Symbol



Festemidler

CNA

CSA

L &lt; 64mm

CNA4.0X35

CSA5.0X35

L &gt; 64mm

CNA4.0X50

CSA5.0X40

Antall

7